

GRADING NOTES:

- 1.) SITE CONTRACTOR SHALL STRIP TOPSOIL AND ANY UNSUITABLE MATERIAL AND PROVIDE STOCKPILE LOCATIONS ON SITE IF NOT SPECIFIED. SEE GENERAL NOTES SHEET (C-1.0, TYP.) FOR GRADING, DRAINAGE, AND EROSION CONTROL SEQUENCE NOTES AND REQUIREMENTS. IN ADDITION, REFERENCE TECHNICAL SPECIFICATIONS AND DETAIL SHEETS FOR MORE INFORMATION.
- 2.) SEE GRADING AND DRAINAGE PLANS FOR FINISH GRADES AND STORM PIPE SCHEDULE.
- 3.) A GEOTECHNICAL ENGINEER OR INSPECTORS SHALL BE CONSULTED TO CONFIRM SUITABILITY OF SUBGRADE MATERIAL AND PROPER COMPACTION PER EARTHWORK SPECIFICATIONS IN FILL AREAS.

ASPHALT AREA NOTE:

- 1.) SITE CONTRACTOR SHALL STRIP TOPSOIL AND ANY UNSUITABLE MATERIAL AND PROVIDE CUT/FILL OPERATIONS TO PROVIDE A COMPACTED CONTROLLED SUBGRADE, IN ACCORDANCE WITH THE SUBSURFACE GEOTECHNICAL EXPLORATION AND TECHNICAL SPECIFICATIONS.

BUILDING PAD NOTE:

- 1.) SITE CONTRACTOR SHALL STRIP TOPSOIL AND ANY UNSUITABLE MATERIAL AND PROVIDE CUT/FILL OPERATIONS TO PROVIDE A COMPACTED CONTROLLED BUILDING PAD, IN ACCORDANCE WITH THE SUBSURFACE GEOTECHNICAL EXPLORATION AND TECHNICAL SPECIFICATIONS.

EROSION CONTROL NOTES:

- 1.) SITE CONTRACTOR TO FOLLOW TYPICAL SEQUENCE OF EROSION CONTROL MEASURES ON GENERAL NOTES, SHEET C-1.0
- 2.) THE PONDS WILL BE USED AS SEDIMENT STORAGE DEVICES WITH DIVERSION DITCHES CARRYING THE MAJORITY OF CLEARING DRAINAGE TO THE SEDIMENT BASINS. AS PHASE 2 IS CONSTRUCTED, STORM DRAIN AND GRADING WILL REDIRECT DRAINAGE AS NECESSARY. SILT FENCE SHALL REMAIN IN-PLACE DURING PHASE I AND II CONSTRUCTION ACTIVITIES.
- 3.) PHASE II EROSION CONTROL CAN BE FOUND ON THE FINAL GRADING AND DRAINAGE SHEETS, C-3.4-3.6.
- 4.) MOST RESIDENTIAL LOTS ARE TO BE LEFT IN NATURAL STATE WITH TREES. SO FOLLOW DEVELOPER'S PHASING PLANS AND UTILIZE EROSION CONTROL MEASURES IF NEEDED IN AND AROUND LOTS. ALSO LOOK AT THE INDIVIDUAL LOT EROSION CONTROL DETAILS ONCE THE LOT IS READY FOR BUILDING.

LIMITS OF DISTURBANCE:

LIMITS OF DISTURBANCE = 56.0 ACRES (MARCH 2022 REVISION)

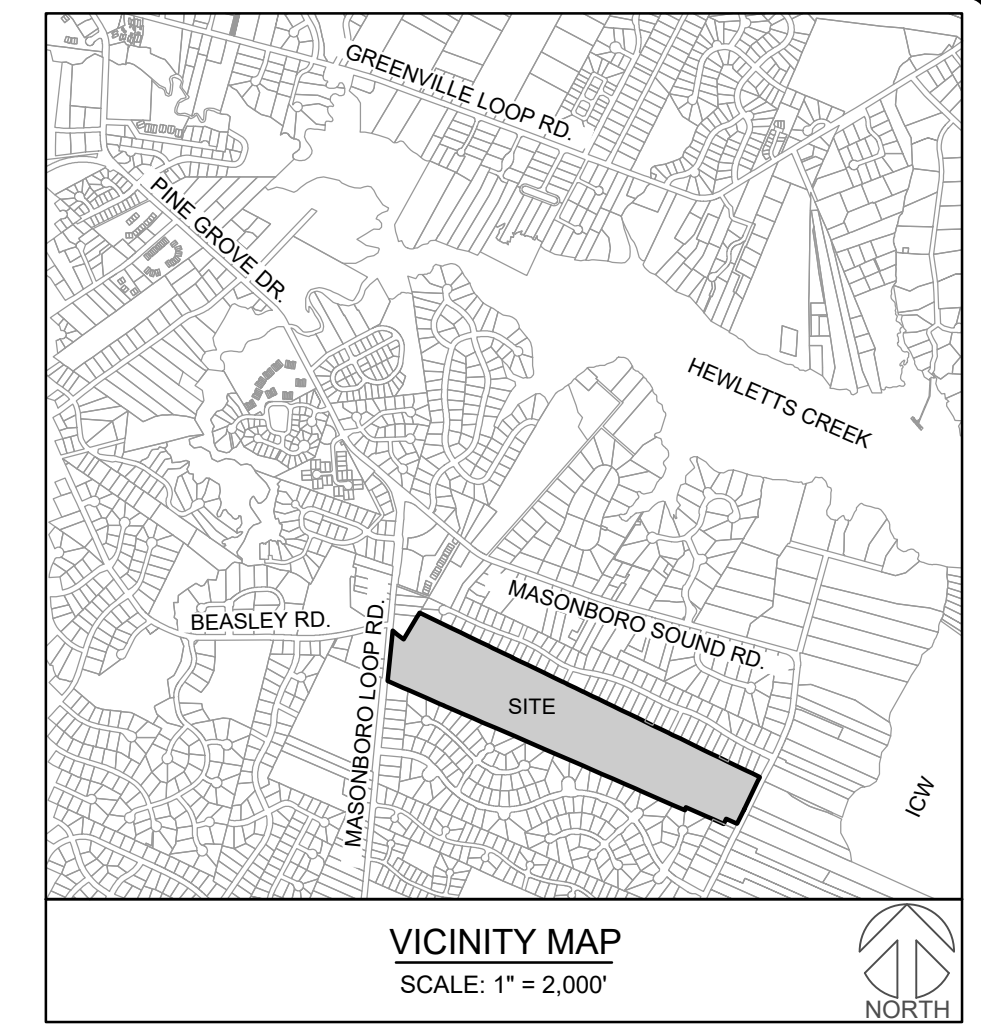

EROSION CONTROL LEGEND:

— LOD — LOD	LIMITS OF DISTURBANCE
— ○ — ○ —	SILT FENCE
— TPF — TPF	TREE PROTECTION FENCING
— >> — >>	TEMP. DIVERSION DITCHES
— 20 — 20	PROPOSED CONTOURS
— 20 — 20	EXISTING CONTOURS
— [Symbol] —	SILT FENCE STONE OUTLET
— [Symbol] —	WATTLE OR RIP-RAP CHECK DAM
— [Symbol] —	TREE REMOVAL
— [Symbol] —	INLET PROTECTION
— [Symbol] —	GRAVEL ENTRANCE
— [Symbol] —	RIP-RAP
— [Symbol] —	VEGETATION PER TYPE

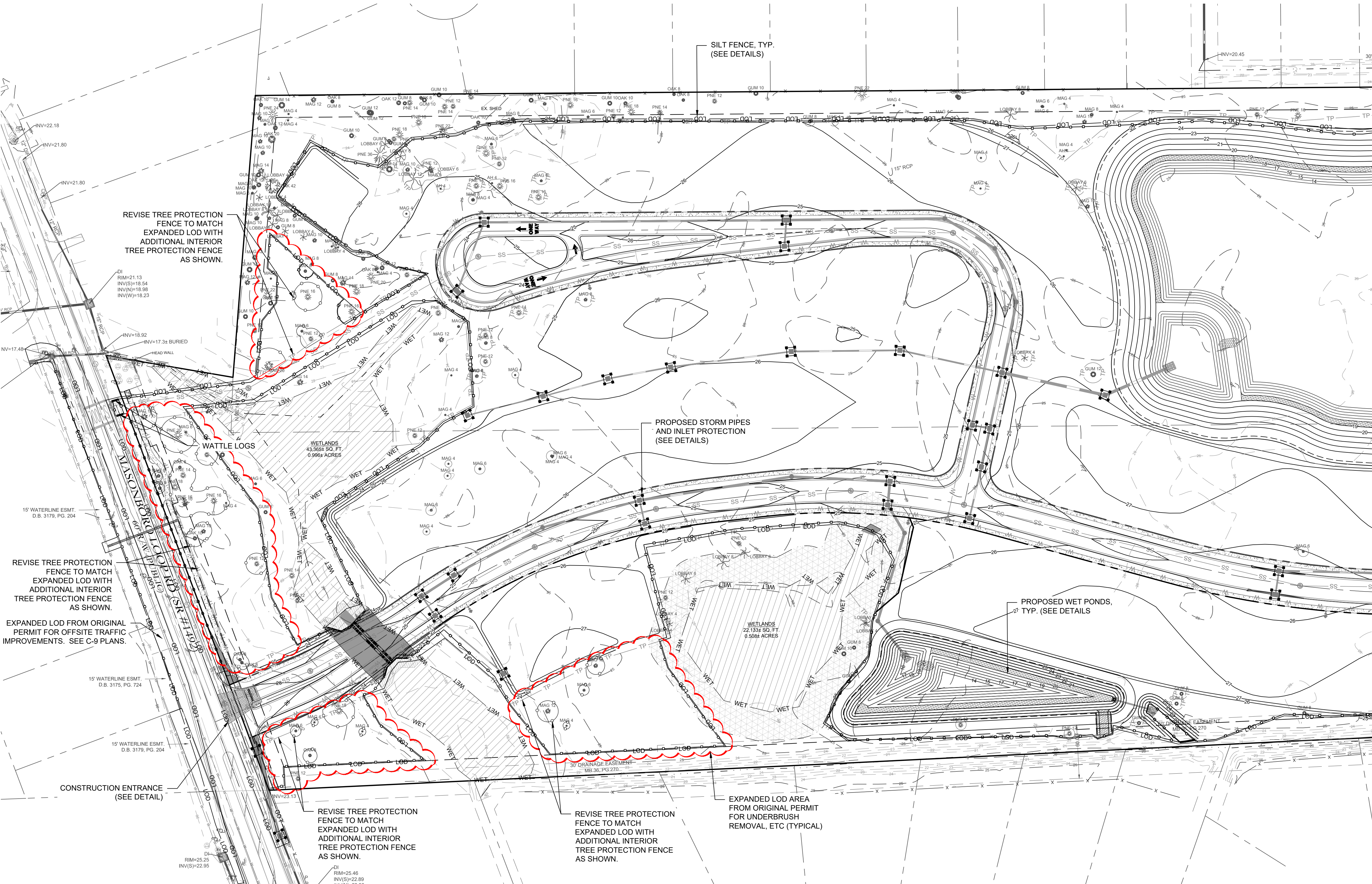

MATCHLINE - SEE SHEET C-3.5

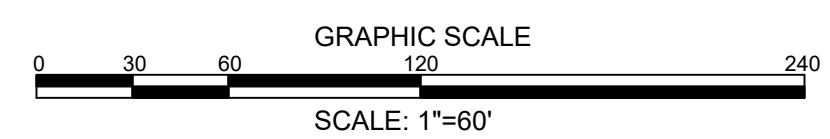

REVISIONS: A) REVISED PER N.C. LAND DISTURBANCE COMMENTS 07.17.2020 B) REVISED PER N.C. LAND DISTURBANCE COMMENTS 08.24.2020 C) MINOR REVISIONS TO PLANS PER N.C. COMMENTS 12.02.2020 D) MINOR REVISIONS TO PLANS PER N.C. COMMENTS 12.07.2020 E) ADDED ADDITIONAL LOD AREAS 03.14.2022	CLIENT INFORMATION: RALEIGH WILMINGTON INVESTORS, LLC. 6131 FALLS OF NEUSE RD. RALEIGH, NC 27609
	PARAMOUNT ENGINEERING 122 Cinema Drive Wilmington, North Carolina 28403 (910) 791-6707 (O) (910) 791-6700 (F) NC License #: C-2846
	EROSION CONTROL PLAN PHASE II EAST & MASON 7500 MASONBORO SOUND RD WILMINGTON, NC; NEW HANOVER COUNTY
	PROJECT STATUS: CONCEPTUAL LAYOUT: _____ FINAL DESIGN: _____ RELEASED FOR CONST: _____ DRAWING INFORMATION: DATE: 08.24.22 SCALE: 1"=60' DRAWN: [Signature] CHECKED: [Signature]

FINAL DESIGN

C-3.4

PEI JOB#: 19409.PE

MATCHLINE - SEE SHEET C-3.4

MATCHLINE - SEE SHEET C-3.6

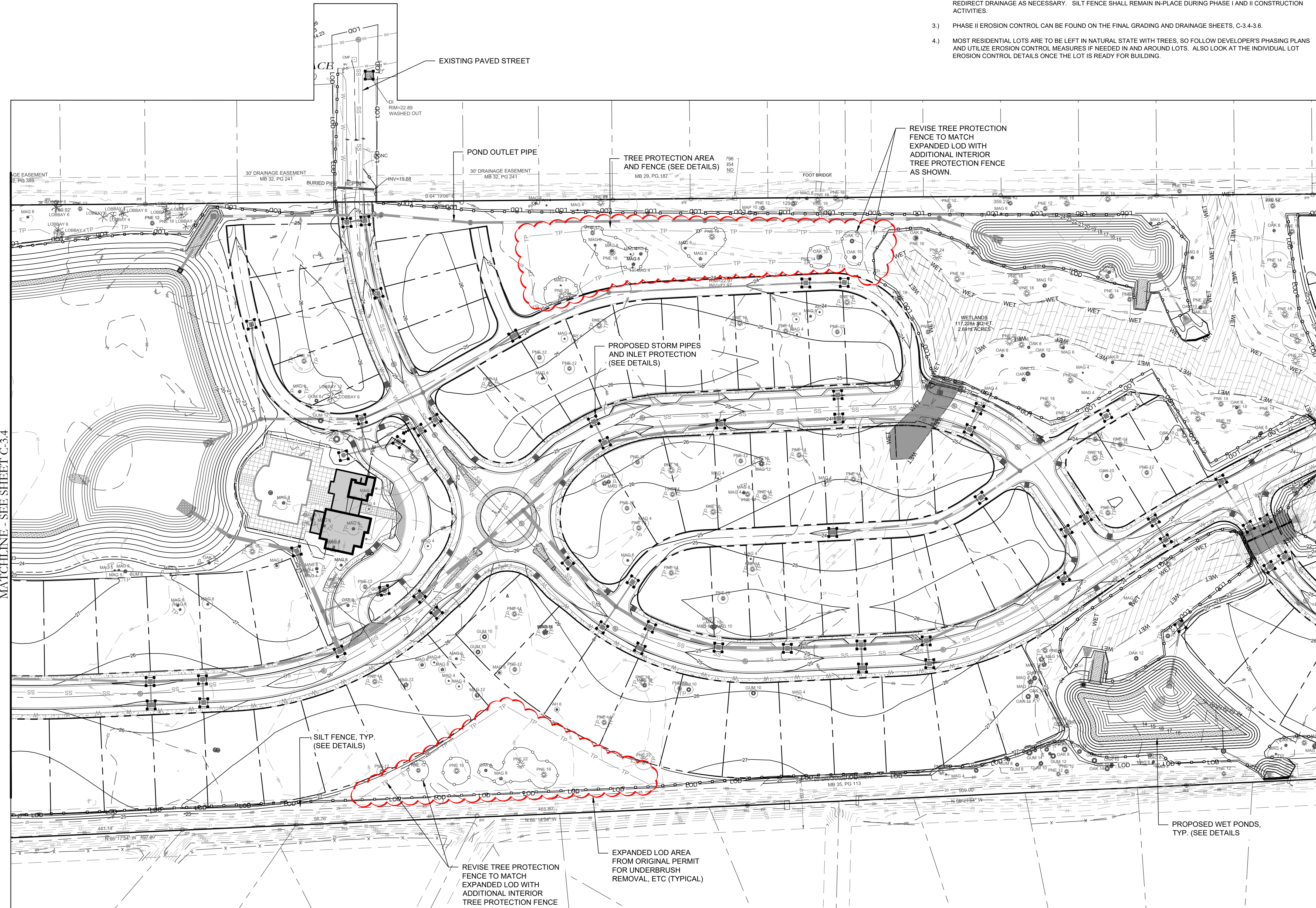

GRADING NOTES:

- 1) SITE CONTRACTOR SHALL STRIP TOPSOIL AND ANY UNSUITABLE MATERIAL AND PROVIDE STOCKPILE LOCATIONS ON SITE IF NOT SPECIFIED. SEE GENERAL NOTES SHEET (C-1.0, TYP.) FOR GRADING, DRAINAGE, AND EROSION CONTROL SEQUENCE NOTES AND REQUIREMENTS. IN ADDITION, REFERENCE TECHNICAL SPECIFICATIONS AND DETAIL SHEETS FOR MORE INFORMATION.
- 2) SEE GRADING AND DRAINAGE PLANS FOR FINISH GRADES AND STORM PIPE SCHEDULE.
- 3) A GEOTECHNICAL ENGINEER OR INSPECTORS SHALL BE CONSULTED TO CONFIRM SUITABILITY OF SUBGRADE MATERIAL AND PROPER COMPACTION PER EARTHWORK SPECIFICATIONS IN FILL AREAS.

ASPHALT AREA NOTE:

- 1) SITE CONTRACTOR SHALL STRIP TOPSOIL AND ANY UNSUITABLE MATERIAL AND PROVIDE CUT/FILL OPERATIONS TO PROVIDE A COMPACTED CONTROLLED SUBGRADE, IN ACCORDANCE WITH THE SUBSURFACE GEOTECHNICAL EXPLORATION AND TECHNICAL SPECIFICATIONS.

BUILDING PAD NOTE:

- 1) SITE CONTRACTOR SHALL STRIP TOPSOIL AND ANY UNSUITABLE MATERIAL AND PROVIDE CUT/FILL OPERATIONS TO PROVIDE A COMPACTED CONTROLLED BUILDING PAD, IN ACCORDANCE WITH THE SUBSURFACE GEOTECHNICAL EXPLORATION AND TECHNICAL SPECIFICATIONS.

EROSION CONTROL NOTES:

- 1) SITE CONTRACTOR TO FOLLOW TYPICAL SEQUENCE OF EROSION CONTROL MEASURES ON GENERAL NOTES, SHEET C-1.0
- 2) THE PONDS WILL BE USED AS SEDIMENT STORAGE DEVICES WITH DIVERSION DITCHES CARRYING THE MAJORITY OF CLEARING DRAINAGE TO THE SEDIMENT BASINS. AS PHASE 2 IS CONSTRUCTED, STORM DRAIN AND GRADING WILL REDIRECT DRAINAGE AS NECESSARY. SILT FENCE SHALL REMAIN IN-PLACE DURING PHASE I AND II CONSTRUCTION ACTIVITIES.
- 3) PHASE II EROSION CONTROL CAN BE FOUND ON THE FINAL GRADING AND DRAINAGE SHEETS, C-3.4-3.6.
- 4) MOST RESIDENTIAL LOTS ARE TO BE LEFT IN NATURAL STATE WITH TREES, SO FOLLOW DEVELOPER'S PHASING PLANS AND UTILIZE EROSION CONTROL MEASURES IF NEEDED IN AND AROUND LOTS. ALSO LOOK AT THE INDIVIDUAL LOT EROSION CONTROL DETAILS ONCE THE LOT IS READY FOR BUILDING.

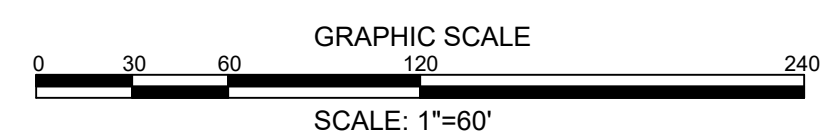
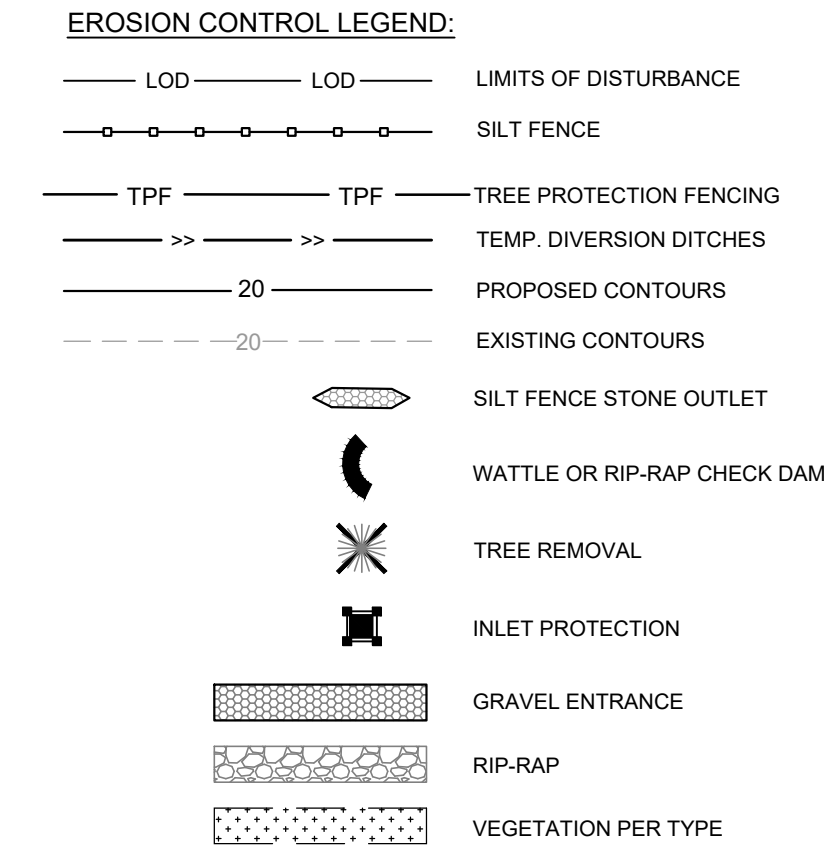
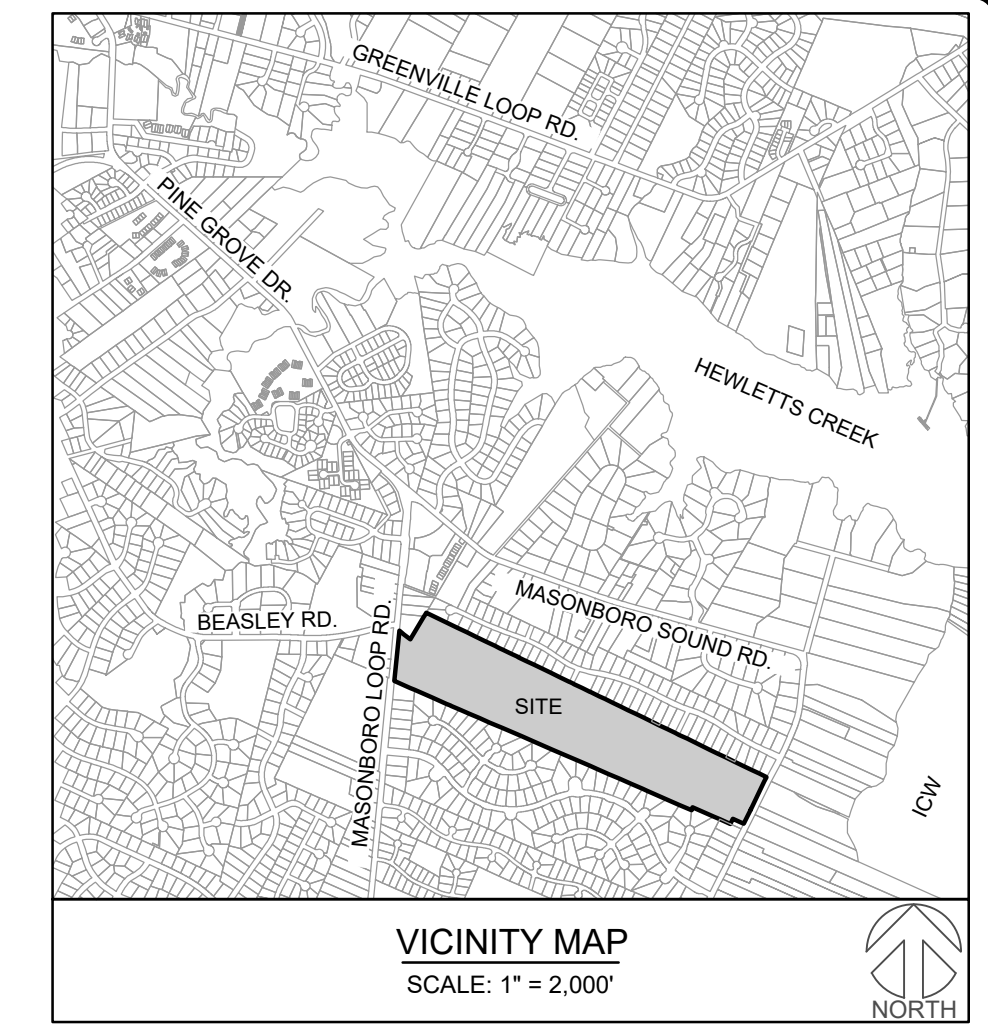

REVISIONS:

A) REVISED PER NHC LAND DISTURBANCE COMMENTS	07.17.2020
B) REVISED PER NHC LAND DISTURBANCE COMMENTS	08.24.2020
C) MINOR REVISIONS TO PLANS PER NHC COMMENTS	12.02.2020
D) ADDED ADDITIONAL LOD AREAS	03.14.2022

CLIENT INFORMATION:
RALEIGH WILMINGTON INVESTORS, LLC.
 6131 FALLS OF NEUSE RD.
 RALEIGH, NC 27609

PARAMOUNT ENGINEERING
 122 Cinema Drive
 Wilmington, North Carolina 28403
 (910) 791-6707 (O) (910) 791-6700 (F)
 NC License #: C-2846

EROSION CONTROL PLAN PHASE II
EAST & MASON
 7500 MASONBORO SOUND RD
 WILMINGTON, NC; NEW HANOVER COUNTY

PROJECT STATUS:
 CONCEPTUAL LAYOUT: _____
 FINAL DESIGN: _____
 RELEASED FOR CONSTRUCTION: _____

DRAWING INFORMATION:
 DATE: 08.24.20
 SCALE: 1" = 60'
 DESIGNED: _____
 DRAWN: _____
 CHECKED: _____

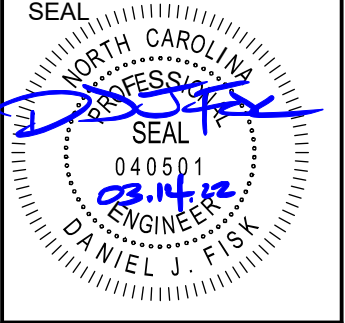

C-3.5
 PEI JOB#: 19409.PE

FINAL DESIGN

MATCHLINE - SEE SHEET C-3.5

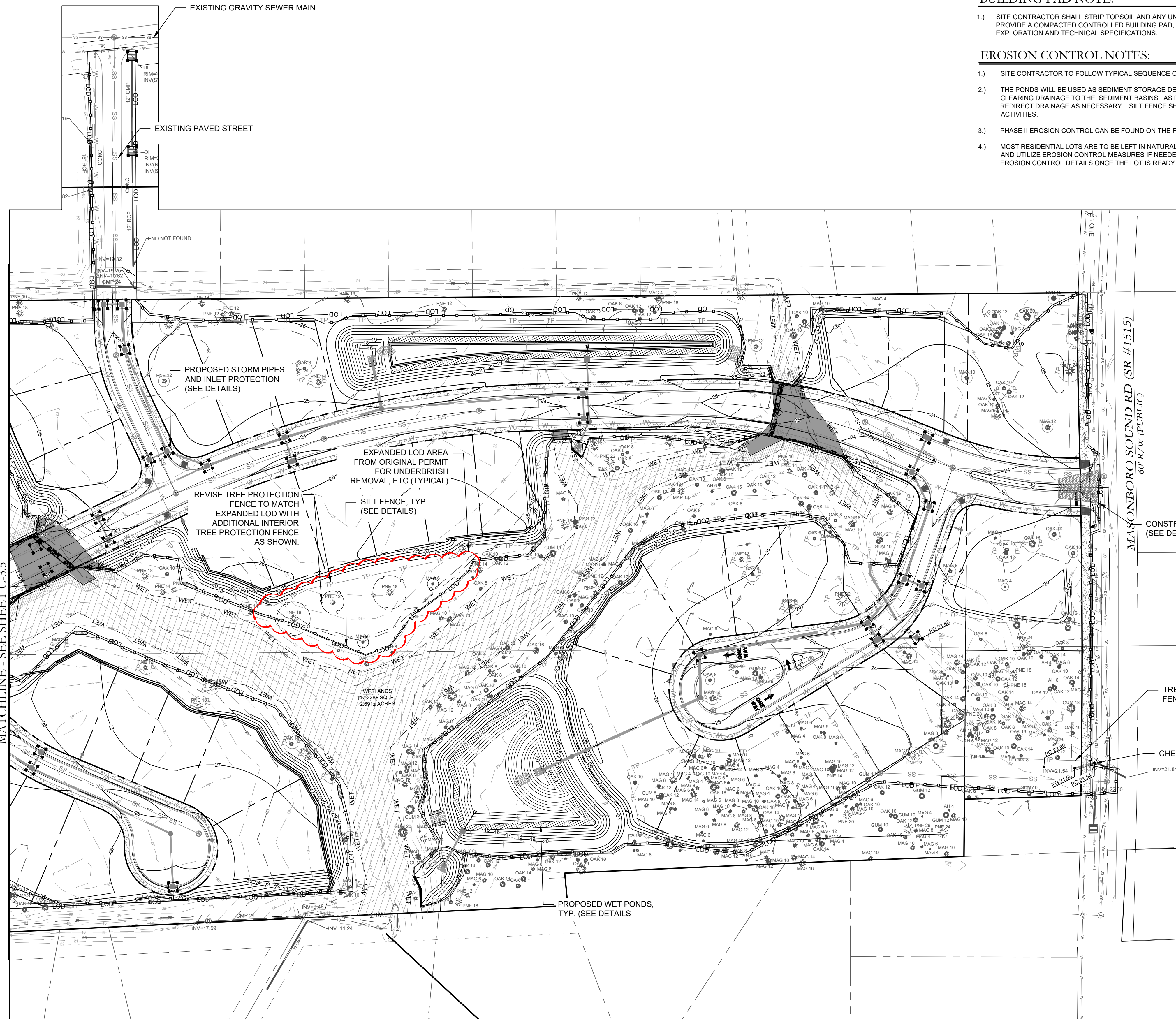

GRADING NOTES:

- 1.) SITE CONTRACTOR SHALL STRIP TOPSOIL AND ANY UNSUITABLE MATERIAL AND PROVIDE STOCKPILE LOCATIONS ON SITE IF NOT SPECIFIED. SEE GENERAL NOTES SHEET (C-1.0, TYP.) FOR GRADING, DRAINAGE, AND EROSION CONTROL SEQUENCE NOTES AND REQUIREMENTS. IN ADDITION, REFERENCE TECHNICAL SPECIFICATIONS AND DETAIL SHEETS FOR MORE INFORMATION.
- 2.) SEE GRADING AND DRAINAGE PLANS FOR FINISH GRADES AND STORM PIPE SCHEDULE.
- 3.) A GEOTECHNICAL ENGINEER OR INSPECTORS SHALL BE CONSULTED TO CONFIRM SUITABILITY OF SUBGRADE MATERIAL AND PROPER COMPACTION PER EARTHWORK SPECIFICATIONS IN FILL AREAS.

ASPHALT AREA NOTE:

- 1.) SITE CONTRACTOR SHALL STRIP TOPSOIL AND ANY UNSUITABLE MATERIAL AND PROVIDE CUT/FILL OPERATIONS TO PROVIDE A COMPACTED CONTROLLED SUBGRADE, IN ACCORDANCE WITH THE SUBSURFACE GEOTECHNICAL EXPLORATION AND TECHNICAL SPECIFICATIONS.

BUILDING PAD NOTE:

- 1.) SITE CONTRACTOR SHALL STRIP TOPSOIL AND ANY UNSUITABLE MATERIAL AND PROVIDE CUT/FILL OPERATIONS TO PROVIDE A COMPACTED CONTROLLED BUILDING PAD, IN ACCORDANCE WITH THE SUBSURFACE GEOTECHNICAL EXPLORATION AND TECHNICAL SPECIFICATIONS.

EROSION CONTROL NOTES:

- 1.) SITE CONTRACTOR TO FOLLOW TYPICAL SEQUENCE OF EROSION CONTROL MEASURES ON GENERAL NOTES, SHEET C-1.0
- 2.) THE PONDS WILL BE USED AS SEDIMENT STORAGE DEVICES WITH DIVERSION DITCHES CARRYING THE MAJORITY OF CLEARING DRAINAGE TO THE SEDIMENT BASINS. AS PHASE 2 IS CONSTRUCTED, STORM DRAIN AND GRADING WILL REDIRECT DRAINAGE AS NECESSARY. SILT FENCE SHALL REMAIN IN-PLACE DURING PHASE I AND II CONSTRUCTION ACTIVITIES.
- 3.) PHASE II EROSION CONTROL CAN BE FOUND ON THE FINAL GRADING AND DRAINAGE SHEETS, C-3.4-3.6.
- 4.) MOST RESIDENTIAL LOTS ARE TO BE LEFT IN NATURAL STATE WITH TREES, SO FOLLOW DEVELOPER'S PHASING PLANS AND UTILIZE EROSION CONTROL MEASURES IF NEEDED IN AND AROUND LOTS. ALSO LOOK AT THE INDIVIDUAL LOT EROSION CONTROL DETAILS ONCE THE LOT IS READY FOR BUILDING.

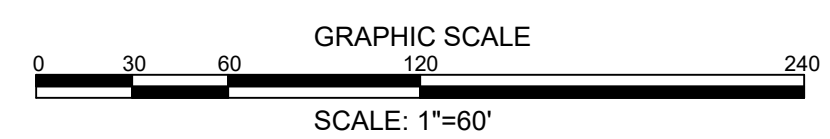
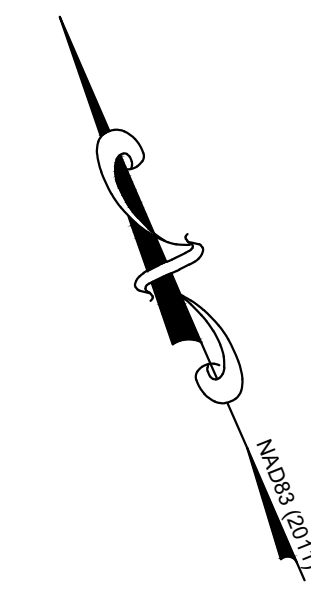
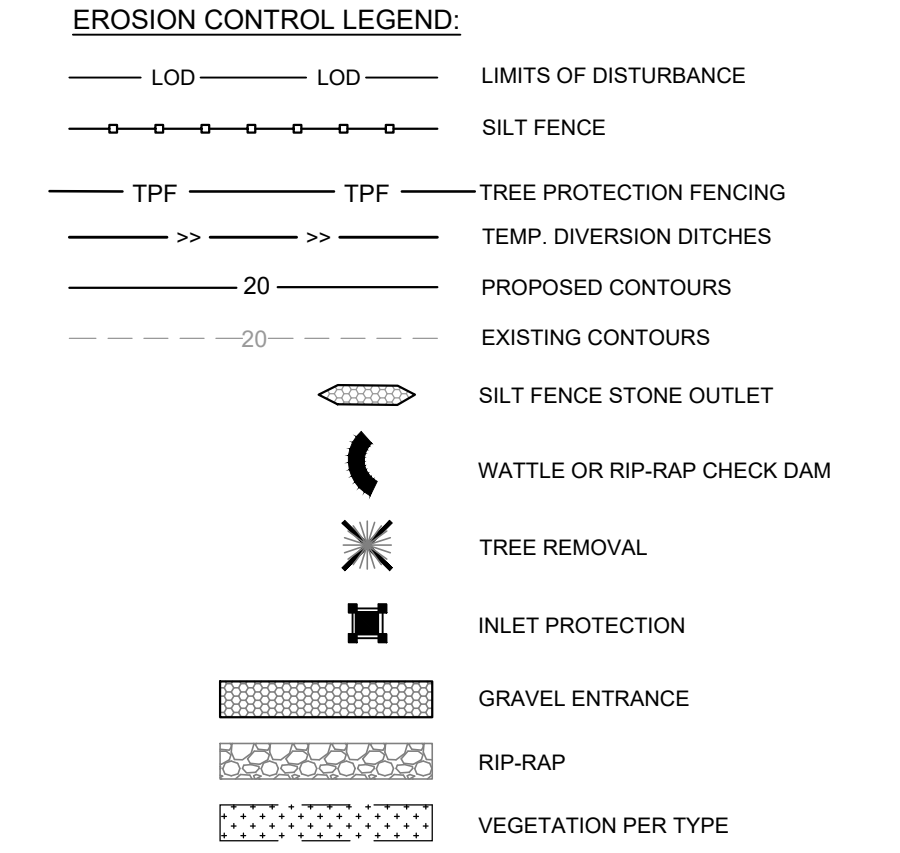
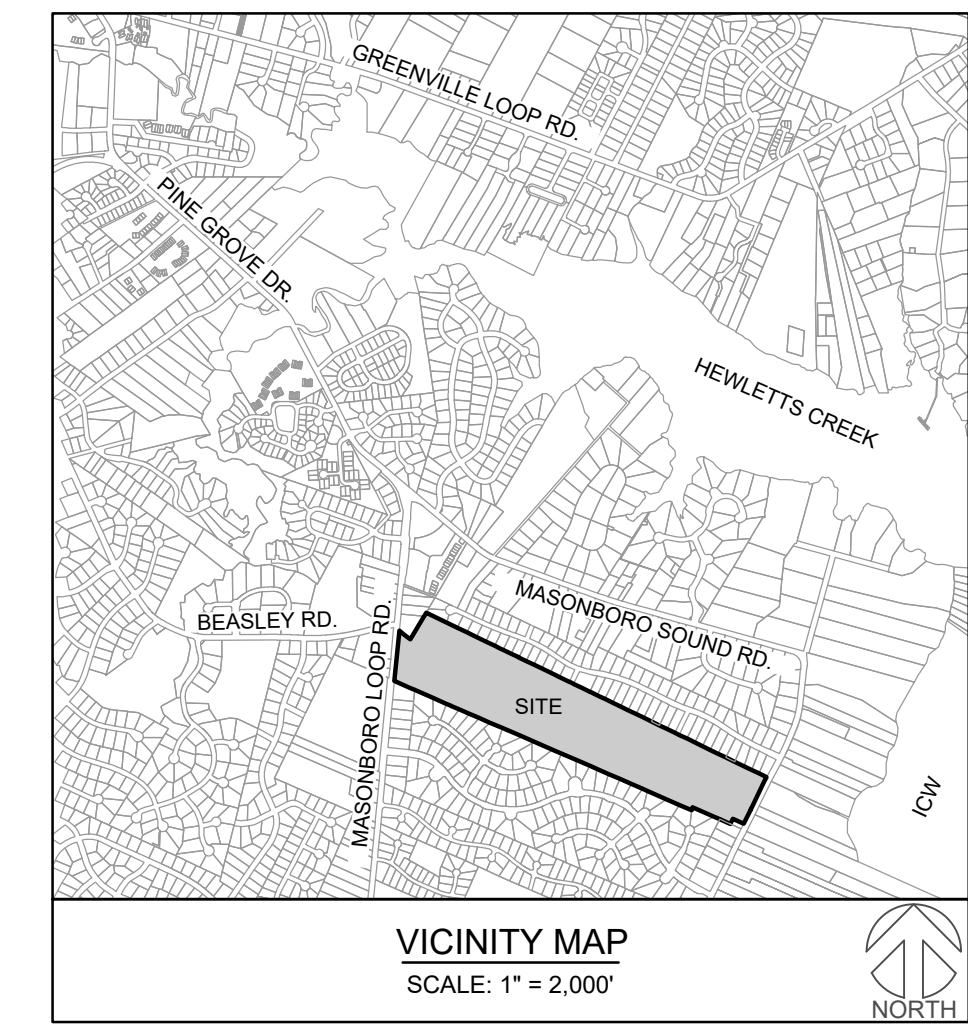

REVISIONS:

07.17.2020	A) REVISED PER N.C. LAND DISTURBANCE COMMENTS
08.24.2020	A) REVISED PER N.C. LAND DISTURBANCE COMMENTS
12.02.2020	C) MINOR REVISIONS TO PLANS PER N.C. COMMENTS
03.14.2022	D) ADDED ADDITIONAL LOD AREAS

CLIENT INFORMATION:

RALEIGH WILMINGTON INVESTORS, LLC.
6131 FALLS OF NEUSE RD.
RALEIGH, NC 27609

PARAMOUNT ENGINEERING
122 Cinema Drive
Wilmington, North Carolina 28403
(910) 791-6707 (O) (910) 791-6700 (F)
NC License #: C-2846

**EROSION CONTROL PLAN
PHASE II**

EAST & MASON
7500 MASONBORO SOUND RD
WILMINGTON, NC; NEW HANOVER COUNTY

PROJECT STATUS
CONCEPTUAL LAYOUT:
FINAL DESIGN:
RELEASED FOR CONSTRUCTION

DRAWING INFORMATION
DATE: 08.24.20
SCALE: 1"=60'
DESIGNED: JFC
DRAWN: JFC
CHECKED: JFC



C-3.6

PEI JOB#: 19409.PE

FINAL DESIGN

STORM SEWER SCHEDULE:

Upstream Node	Downstream Node	Diameter (in)	Upstream Invert	Downstream Invert	Pipe Length (ft)	Slope (%)	Upstream Rim Elev	Downstream Rim Elev	Pipe Material
OS-CB 101	OS-DI 100	15	23.52	23.20	99	0.32	26.42	26.00	RCP IV
OS-FES 103	OS-CB 101	15	23.85	23.52	99	0.33	-	26.42	RCP IV
OS-FES-201	OS-DI 200	15	21.00	17.48	44	8.02	-	21.50	RCP III
OS-FES-202	OS-DI 200	18	20.00	18.50	20	7.49	-	21.50	RCP III

NOTE: ALL DRAINAGE STRUCTURES LOCATED UNDER PAVEMENT SHALL MEET LATEST NDCOT STANDARDS FOR TRAFFIC LOADING.

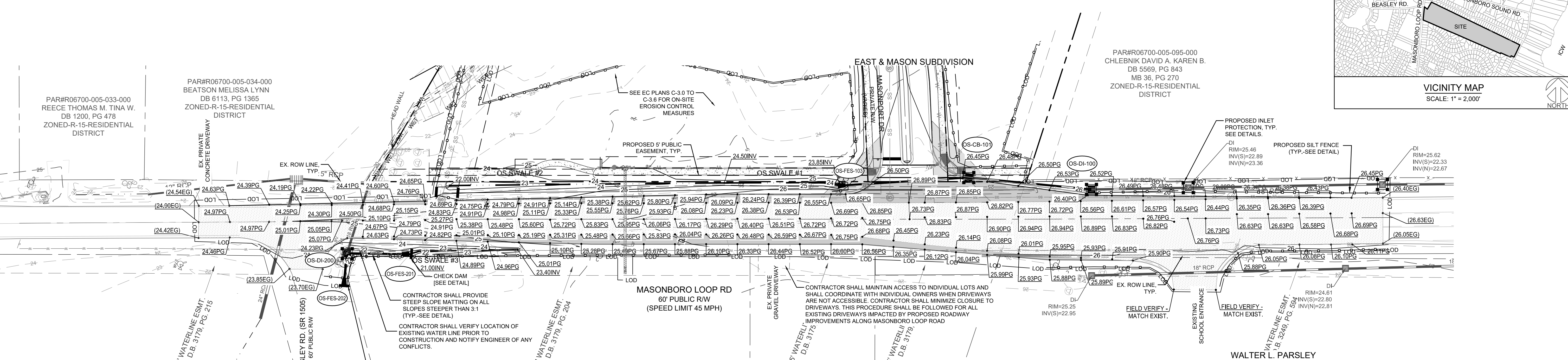
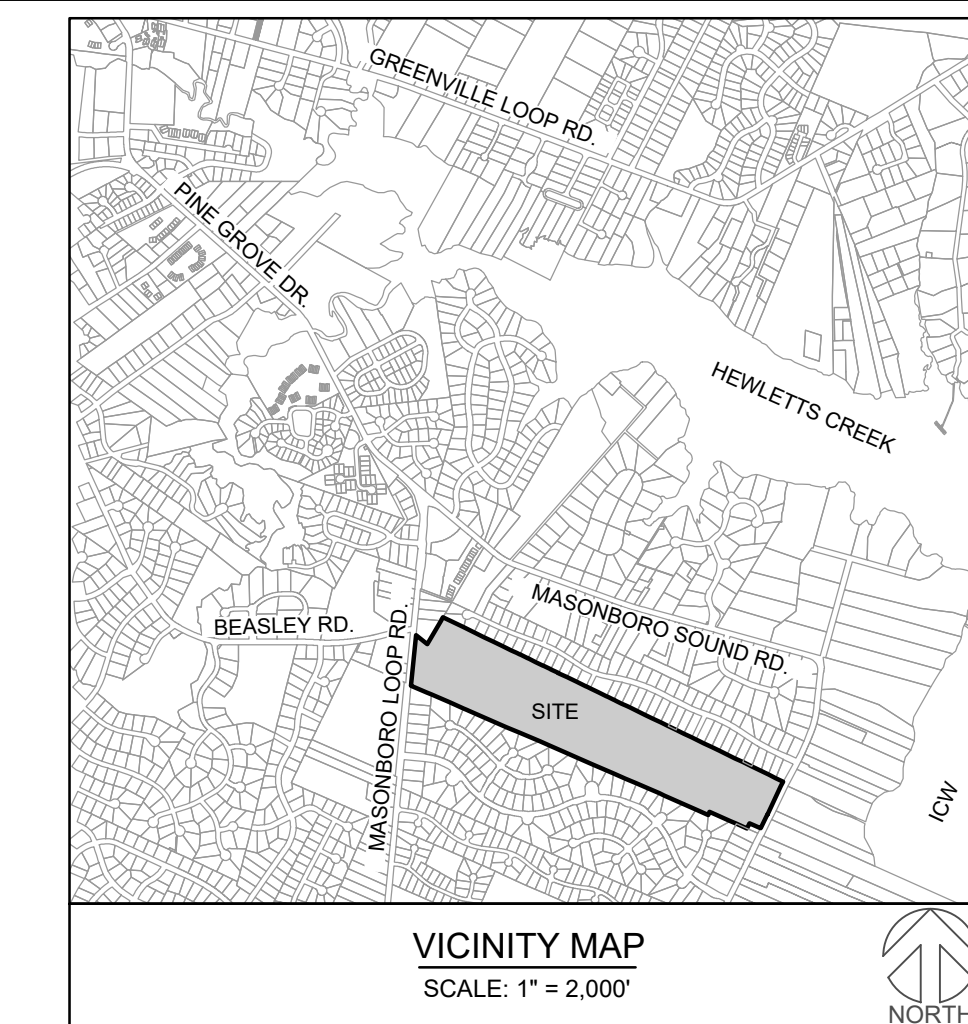

PLAN VIEW (STATION 10+00-21+00)
SCALE: 1"=40'

SITE AREA DESCRIPTION	STABILIZATION	TIMEFRAME EXCEPTIONS
PERIMETER DIKES, SWALES, DITCHES AND SLOPES	7 DAYS	NONE
HIGH QUALITY WATER (HQW) ZONES	7 DAYS	NONE
SLOPES STEEPER THAN 3:1	7 DAYS	IF SLOPES ARE 10' OR LESS IN LENGTH AND ARE NOT STEEPER THAN 2:1, 14 DAYS ARE ALLOWED
SLOPES 3:1 OR FLATTER	14 DAYS	7 DAYS FOR SLOPES GREATER THAN 50' IN LENGTH
ALL OTHER AREAS WITH SLOPES FLATTER THAN 4:1	14 DAYS	NONE, EXCEPT FOR PERIMETERS AND HQW ZONES

EROSION CONTROL AND SEQUENCE OF CONSTRUCTION NOTES:

- NOTE: THESE EROSION CONTROL AND SEQUENCE OF CONSTRUCTION NOTES ARE INTENDED FOR EACH "PHASE" OF CONSTRUCTION. THE ORDER AND STEPS TAKEN MUST BE IMPLEMENTED AS EACH PART OF THE PROJECT IS DEVELOPED; WHETHER AS A WHOLE OR IN PHASES. ANY EROSION CONTROL DEVICES/MEASURES MUST REMAIN IN PLACE UNTIL ALL DISTURBED AREAS ARE STABILIZED AND ALL IMPROVEMENTS ARE COMPLETE.
- CONSTRUCT TEMPORARY GRAVEL CONSTRUCTION ENTRANCE(S), ESTABLISH THE LIMITS OF DISTURBANCE, AND TEMPORARY SILT FENCE.
 - CLEAR AND REMOVE FROM SITE ALL TREES (ONLY ONES TO BE REMOVED), ROOTS, ROOT MAT, ETC. FROM THE AREA WITHIN THE DESIGNATED CLEARING LIMITS.
 - INSTALL REMAINING EROSION CONTROL MEASURES AS SHOWN ON THE PLANS WITHIN THE AREA DISTURBED. ALL EROSION CONTROL MEASURES MUST BE INSTALLED BEFORE COMMENCING CONSTRUCTION.
 - PLANT GRASS OVER ALL GRADED AREAS WITHIN 14 WORKING DAYS OF CEASE OF ANY GRADING ACTIVITY.
 - IMMEDIATELY UPON THE INSTALLATION OF ANY STORM DRAINAGE CATCH BASIN, DROP INLET, ETC., THE CONTRACTOR SHALL INSTALL INLET PROTECTION TO STOP ANY SEDIMENT FROM ENTERING THE DRAINAGE SYSTEM.
 - THE CONTRACTOR SHALL BE RESPONSIBLE FOR CLEANING AND RESTORING TO PRE-CONSTRUCTION CONDITIONS ANY AREAS OUTSIDE THE PROJECT LIMITS THAT MAY INADVERTENTLY BE DAMAGED DUE TO THE FAILURE OF THE EROSION CONTROL MEASURES.
 - DURING GRADING AND AFTER GRADING HAS BEEN COMPLETED, THE CONTRACTOR SHALL CONTINUE TO MAINTAIN PERMANENT AND TEMPORARY EROSION CONTROL MEASURES UNTIL FINAL APPROVAL.
 - UPON RECEIVING FINAL APPROVAL, THE CONTRACTOR CAN REMOVE TEMPORARY EROSION CONTROL MEASURES.
 - THE CONTRACTOR SHALL CONTINUE TO WATER, FERTILIZE, MOW AND MAINTAIN SPRIGGED, SODDED, AND PLANTED AREAS UNTIL ALL CONSTRUCTION IS COMPLETE.

GENERAL EROSION AND SEDIMENT CONTROL NOTES:

- THE EROSION CONTROL PLAN SHALL INCLUDE PROVISIONS FOR GROUND COVER ON ALL EXPOSED PERIMETER DIKES, SWALES, DITCHES, PERIMETER SLOPES AND ALL SLOPES STEEPER THAN 3:1 WITHIN 7 CALENDAR DAYS FROM THE LAST LAND DISTURBING ACTIVITY. GROUND COVER SHALL BE PROVIDED ON ALL OTHER DISTURBED AREAS WITHIN 14 CALENDAR DAYS FROM THE LAST LAND DISTURBING ACTIVITY.
- UNLESS OTHERWISE INDICATED, ALL VEGETATIVE AND STRUCTURAL EROSION AND SEDIMENT CONTROL MEASURES SHALL BE CONSTRUCTED AND MAINTAINED IN ACCORDANCE WITH THE MINIMUM STANDARDS AND SPECIFICATIONS OF THE NORTH CAROLINA EROSION AND SEDIMENT CONTROL HANDBOOK (NO SEPARATE PAYMENT).
- THE CONTRACTOR SHALL NOTIFY PLAN APPROVING AUTHORITY ONE WEEK PRIOR TO THE PRE-CONSTRUCTION CONFERENCE, ONE WEEK PRIOR TO THE COMMENCEMENT OF LAND DISTURBING ACTIVITY, AND ONE WEEK PRIOR TO FINAL INSPECTION.
- ALL EROSION AND SEDIMENT CONTROL MEASURES ARE TO BE PLACED PRIOR TO CLEARING AND/OR LAND DISTURBANCE.
- A COPY OF THE APPROVED EROSION AND SEDIMENT CONTROL PLAN AND PERMIT SHALL BE MAINTAINED ON THE SITE AT ALL TIMES.
- PRIOR TO COMMENCING LAND DISTURBING ACTIVITIES IN AREAS OTHER THAN INDICATED ON THESE PLANS (INCLUDING, BUT NOT LIMITED TO OFF-SITE BORROW OR WASTE AREAS STAGING OR STORAGE AREAS), THE CONTRACTOR SHALL PREPARE AND SUBMIT A SUPPLEMENTARY EROSION CONTROL PLAN TO THE OWNER FOR REVIEW AND TO THE STATE FOR APPROVAL. CONTRACTOR SHALL PAY ALL FEES REQUIRED AND SHALL INSTALL NECESSARY MEASURES AT NO SEPARATE PAYMENT. THE CONTRACTOR SHALL PROVIDE THE OWNER AND THE ENGINEER A COPY OF THE AMENDED PERMIT.
- THE CONTRACTOR IS RESPONSIBLE FOR INSTALLATION OF ANY ADDITIONAL EROSION CONTROL MEASURES NECESSARY TO PREVENT EROSION AND SEDIMENTATION AS DETERMINED BY EITHER THE REVIEWING AGENCY OR THE ENGINEER. (NO SEPARATE PAYMENT).
- ALL DISTURBED AREAS ARE TO DRAIN TO APPROVED SEDIMENT CONTROL MEASURES AT ALL TIMES DURING LAND DISTURBING ACTIVITIES AND DURING SITE DEVELOPMENT UNTIL FINAL STABILIZATION IS ACHIEVED.
- ALL AREAS DISTURBED BY CONSTRUCTION UNLESS OTHERWISE IMPROVED SHALL BE SODDED OR SEEDED AS INDICATED AND STABILIZED.
- DURING DEWATERING OPERATIONS, WATER SHALL BE PUMPED INTO AN APPROVED FILTERING DEVICE PRIOR TO DISCHARGE TO RECEIVING OUTLET.

GENERAL EROSION AND SEDIMENT CONTROL NOTES (CONT.):

- THE CONTRACTOR SHALL INSPECT ALL EROSION CONTROL MEASURES PERIODICALLY AND AFTER EACH RUNOFF-PRODUCING EVENT. ANY NECESSARY REPAIRS OR CLEANUP TO MAINTAIN THE EFFECTIVENESS OF THE EROSION CONTROL DEVICES SHALL BE MADE IMMEDIATELY.
- ALL TEMPORARY EROSION CONTROL MEASURES SHALL BE REMOVED BY CONTRACTOR ONCE STABILIZATION OR A SUFFICIENT GROUND COVER HAS BEEN ESTABLISHED OR AS DIRECTED BY THE ENGINEER. (NO SEPARATE PAYMENT). NCDENR'S FINAL APPROVAL IS REQUIRED.
- TEMPORARY GRAVEL CONSTRUCTION ENTRANCE SHALL BE REQUIRED AT ALL CONSTRUCTION STAGING AREA ENTRANCES AND ALL CONSTRUCTION ACCESS LOCATIONS INTO NON-PAVED AREA. (NO SEPARATE PAYMENT).
- WHEN CROSSING CREEK OR DRAINAGE-WAY, THE DIVISION OF WATER QUALITY SHALL BE CONTACTED PRIOR TO DISTURBING A CREEK. THE CONTRACTOR SHALL INSTALL RIP-RAP WITH FABRIC ALONG DISTURBED BANKS AND CHANNEL AND RESTORE SLOPES TO ORIGINAL CONTOURS, BUT NOT STEEPER THAN 2:1 MAXIMUM. DISTURBED CREEK AREA SHALL BE STABILIZED IMMEDIATELY.

MAINTENANCE PLAN:

- ALL EROSION AND SEDIMENT CONTROL PRACTICES WILL BE CHECKED FOR STABILITY AND OPERATION FOLLOWING EVERY RUNOFF-PRODUCING RAINFALL BUT IN NO CASE LESS THAN ONCE EVERY WEEK. ANY NEEDED REPAIRS WILL BE MADE IMMEDIATELY TO MAINTAIN ALL PRACTICES AS DESIGNED.
- ALL CONSTRUCTION ENTRANCES WILL BE PERIODICALLY TOP DRESSED WITH AN ADDITIONAL 2 INCHES OF #4 STONE TO MAINTAIN PROPER DEPTH. ANY SEDIMENT THAT IS TRACKED INTO THE STREET WILL BE IMMEDIATELY REMOVED.
- SEDIMENT WILL BE REMOVED BEHIND THE SEDIMENT FENCE WHEN IT BECOMES 0.5 FEET DEEP AT THE FENCE. THE SEDIMENT FENCE WILL BE REPAIRED AS NECESSARY TO MAINTAIN A BARRIER. SILT FENCE STAKES WILL BE SPACED 6 FEET APART UNLESS A WIRE BACKING IS USED WITH 8 FOOT STAKE SPACING.
- ALL SEEDED AREAS WILL BE FERTILIZED, RESEED AS NECESSARY, AND MULCHED ACCORDING TO SPECIFICATIONS IN THE VEGETATIVE PLAN TO MAINTAIN A VIGOROUS, DENSE VEGETATIVE COVER.
- INLET PROTECTION - INSPECT WIRE AND ROCK INLET PROTECTION AT LEAST ONCE A WEEK AND AFTER EACH SIGNIFICANT (1/8 INCH OR GREATER) RAINFALL EVENT AND REPAIR IMMEDIATELY. REMOVE SEDIMENT AND RESTORE THE SEDIMENT STORAGE AREA TO ITS ORIGINAL DIMENSIONS WHEN THE SEDIMENT HAS ACCUMULATED TO ONE-HALF THE DESIGN DEPTH OF THE TRAP. PLACE THE SEDIMENT THAT IS REMOVED IN THE DESIGNATED DISPOSAL AREA AND REPLACE THE CONTAMINATED PART OF THE GRAVEL FACING.

PERMANENT SEEDING SCHEDULE - MIXTURE SCP

Seeding Mixture	SPECIES	RATE (LB/ACRE)
	CENTPEDE GRASS	10-20

Seeding Dates
MARCH - JUNE

Soil Amendments
APPLY LIME AND FERTILIZER ACCORDING TO SOIL TESTS, OR APPLY 300 LB/ACRE 10-10-10 FERTILIZER.

Mulch
DO NOT MULCH.

Maintenance
FERTILIZE VERY SPARINGLY--20 LB/ACRE NITROGEN IN SPRING WITH NO PHOSPHORUS. CENTPEDE GRASS CANNOT TOLERATE HIGH PH OR EXCESS FERTILIZER.

TEMPORARY SEEDING-LATE WINTER/EARLY SPRING

SEEDING MIXTURE	SPECIES	RATE (LB/ACRE)
WINTER AND EARLY SPRING	RYE (GRAIN)	120
	ANNUAL LESPEDEZA (KOBÉ IN PIEDMONT AND COASTAL PLAIN, KOREAN IN MOUNTAINS)	50
SUMMER	GERMAN MILLET	40
	RYE (GRAIN)	120

Seeding dates

COASTAL PLAIN - DEC 1-APR. 15 - LATE WINTER AND EARLY SPRING
APRIL 15 - AUG. 15 - SUMMER
AUG. 15 - DEC. 30 - FALL

Soil amendments

FOLLOW RECOMMENDATIONS OF SOIL TESTS OR APPLY 2,000 LB/ACRE GROUND AGRICULTURAL LIMESTONE AND 750 LB/ACRE 10-10-10 FERTILIZER.

Mulch

APPLY 4,000 LB/ACRE STRAW. ANCHOR STRAW BY TACKING WITH ASPHALT, NETTING OR A MULCH ANCHORING TOOL. A DISK WITH BLADES SET NEARLY STRAIGHT CAN BE USED AS A MULCH ANCHORING TOOL.

Maintenance

REFERTILIZE IF GROWTH IS NOT FULLY ADEQUATE. RESEED, REFERTILIZE AND MULCH IMMEDIATELY FOLLOWING EROSION OR OTHER DAMAGE.

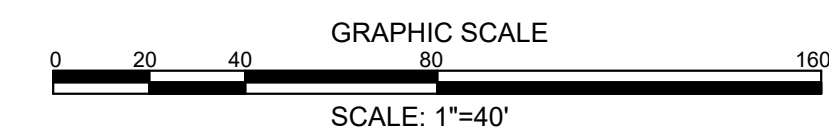
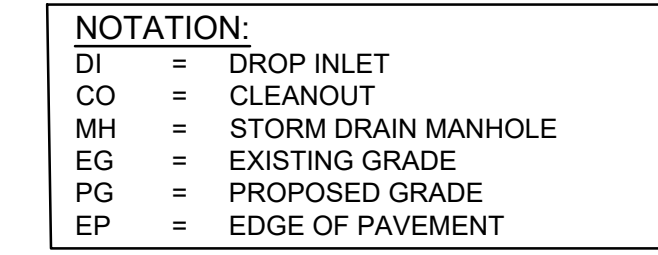
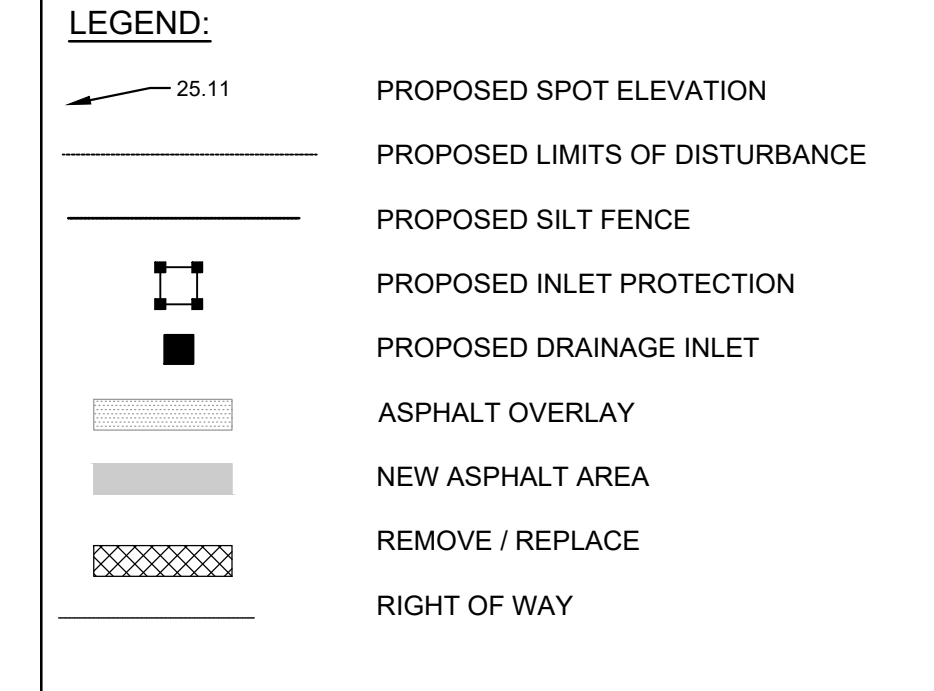

FINAL DESIGN - NOT RELEASED FOR CONSTRUCTION

RALEIGH WILMINGTON INVESTORS, LLC.
6131 FALLS OF NEUSE RD.
RALEIGH, NC 27609

PARAMOUNT ENGINEERING, INC.
122 Cinema Drive
Wilmington, North Carolina 28403
(910) 791-6707 (O) (910) 791-6760 (F)
NC License #: C-2846

MASONBORO LOOP RD (SR 1492) GRADING, DRAINAGE, & EC PLAN
EAST & MASON
7500 MASONBORO SOUND RD
WILMINGTON, NC; NEW HANOVER COUNTY

PROJECT STATUS:
CONCEPTUAL LAYOUT:
PRELIMINARY LAYOUT:
RELEASED FOR CONSTRUCTION

DRAWING INFORMATION:
DATE: 10.12.20
SCALE: 1"=40'
DRAWN BY: J. P. SIK
CHECKED BY: J. P. SIK

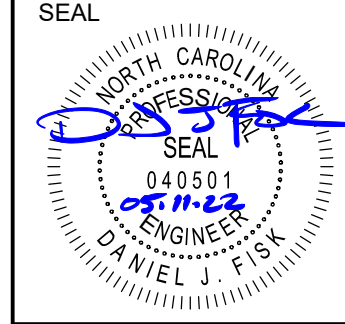

C-9.3

PEI JOB#: 19409.PE

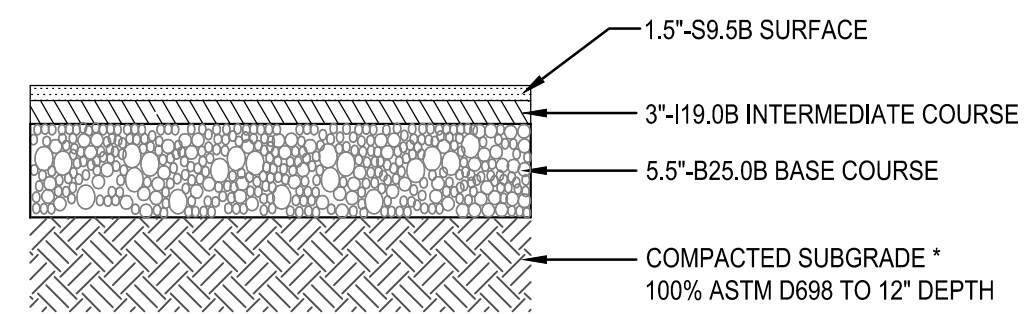

TYPICAL PAVEMENT SECTION
MASONBORO LOOP RD
NOT TO SCALE

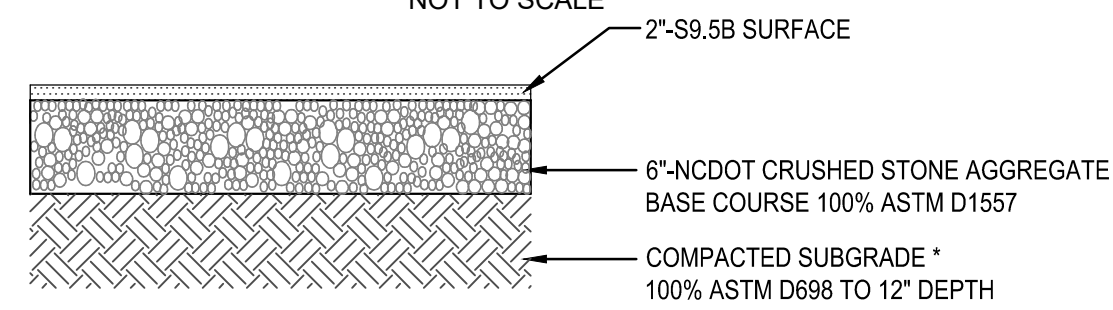

TYPICAL PAVEMENT SECTION
MASONPORT DR.
NOT TO SCALE

FOR TRANSITION SECTION FROM OVERLAY TO EXISTING PAVEMENT, MILL OUT 25' OF EXISTING PAVEMENT (MIN. 1.5\"/>

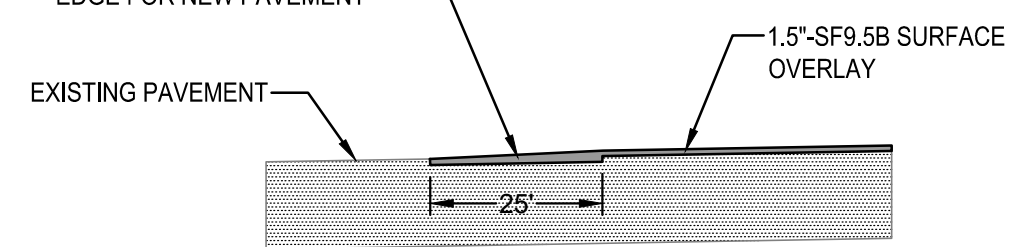

TYPICAL TIE-IN TO EXISTING PAVEMENT
NOT TO SCALE

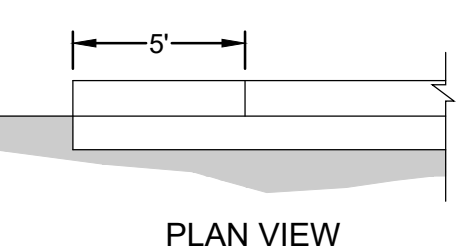
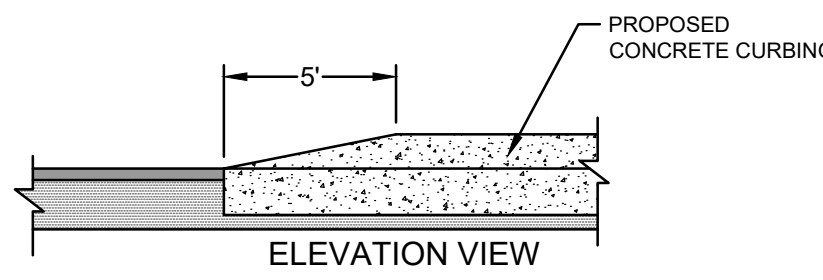

PLAN VIEW
CURB END TAPER DETAIL
NOT TO SCALE

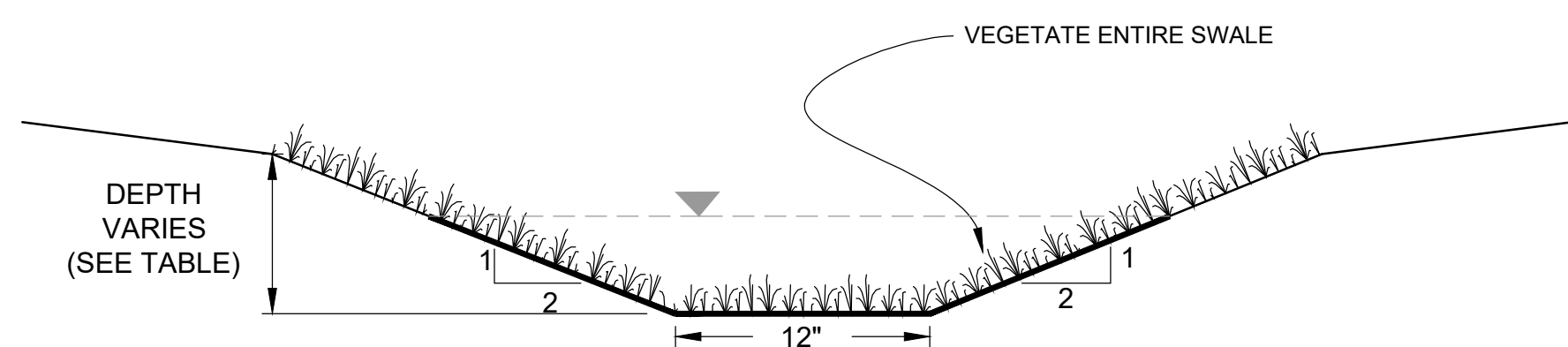

CONVEYANCE SWALES SECTION-OS SWALES 1 & 3
NOT TO SCALE

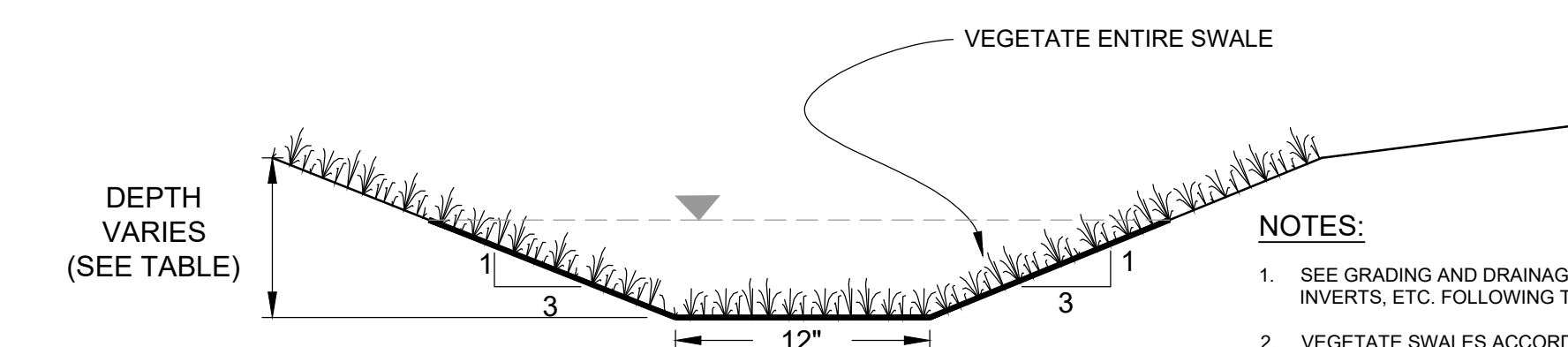

CONVEYANCE SWALES SECTION-OS SWALES 2
NOT TO SCALE

NOTES:

- SEE GRADING AND DRAINAGE PLANS FOR GRADES, INVERTS, ETC. FOLLOWING THIS TYP. SECTION.
- VEGETATE SWALES ACCORDING TO SEEDING SCHEDULE IMMEDIATELY UPON COMPLETION.
- TEMPORARY LINER SHALL BE PLACED ON THE BOTTOM AND UP THE SIDE SLOPES TO MIN. DEPTH OF 1.0 FT; MULCH ACCORDING TO SEEDING SPECIFICATIONS ABOVE THAT HEIGHT. LINER SHALL BE EXCELSIOR MATTING OR COIR FIBER MATTING.
- A MINIMUM OF 0.5' DEPTH SHALL BE ADDED TO EACH SWALE OR, A MINIMUM ELEVATION MAINTAINED AS ANNOTATED ON PLAN, WHICHEVER IS GREATER.
- SEE PLAN FOR HORIZONTAL LOCATION OF SWALES.

SWALE #	RUNOFF			Length	Inv Up	Inv Dwn	S	d	A _v	P	R	V _{actual}	Q _{actual}	CHANNEL		
	A _d	C	Q _{design}											Adequate Capacity?	Lining Required?	No. Check Dams?
1	0.12	0.67	0.66	93	24.50	23.85	0.007	0.35	0.60	2.57	0.23	1.18	0.70	Y	N	0.0
3	0.84	0.45	3.08	93	23.40	21.00	0.026	0.55	1.16	3.46	0.33	2.88	3.32	Y	Y	1.2

SWALE #	RUNOFF			Length	Inv Up	Inv Dwn	S	d	A _v	P	R	V _{actual}	Q _{actual}	CHANNEL		
	A _d	C	Q _{design}											Adequate Capacity?	Lining Required?	No. Check Dams?
2	0.21	0.62	1.06	224	24.50	21.90	0.012	0.40	0.88	3.53	0.25	1.59	1.40	Y	N	1.3

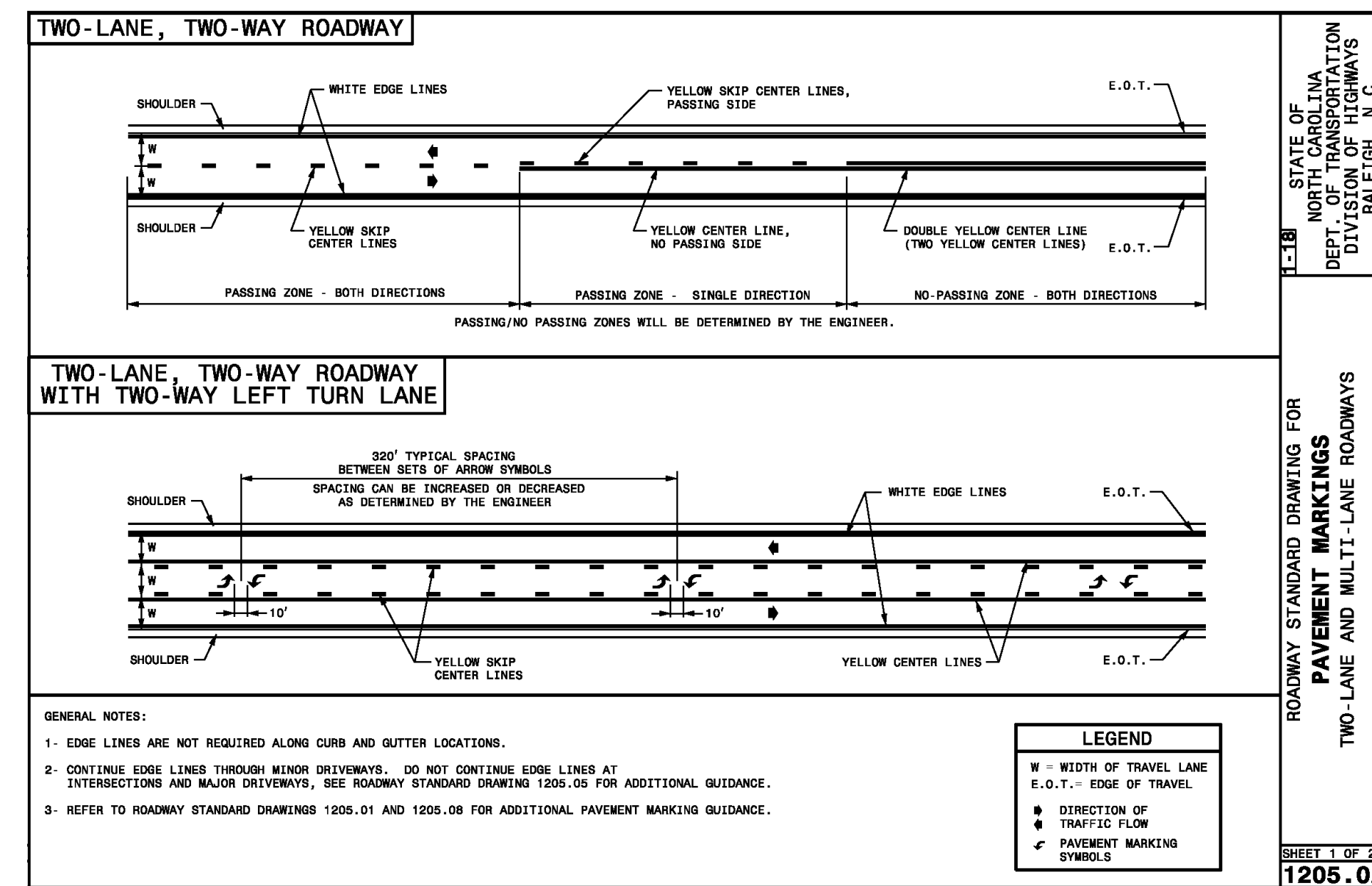
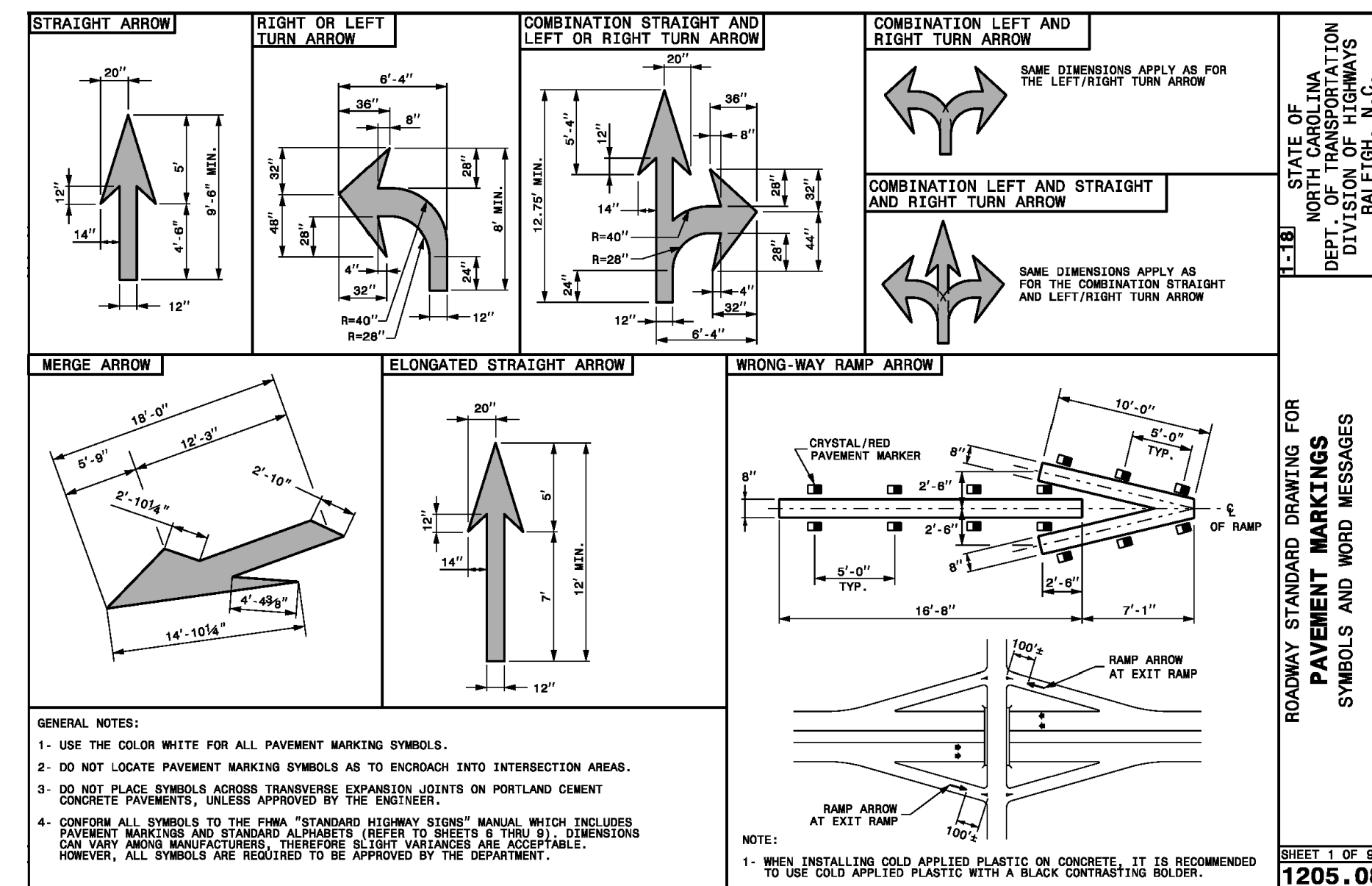
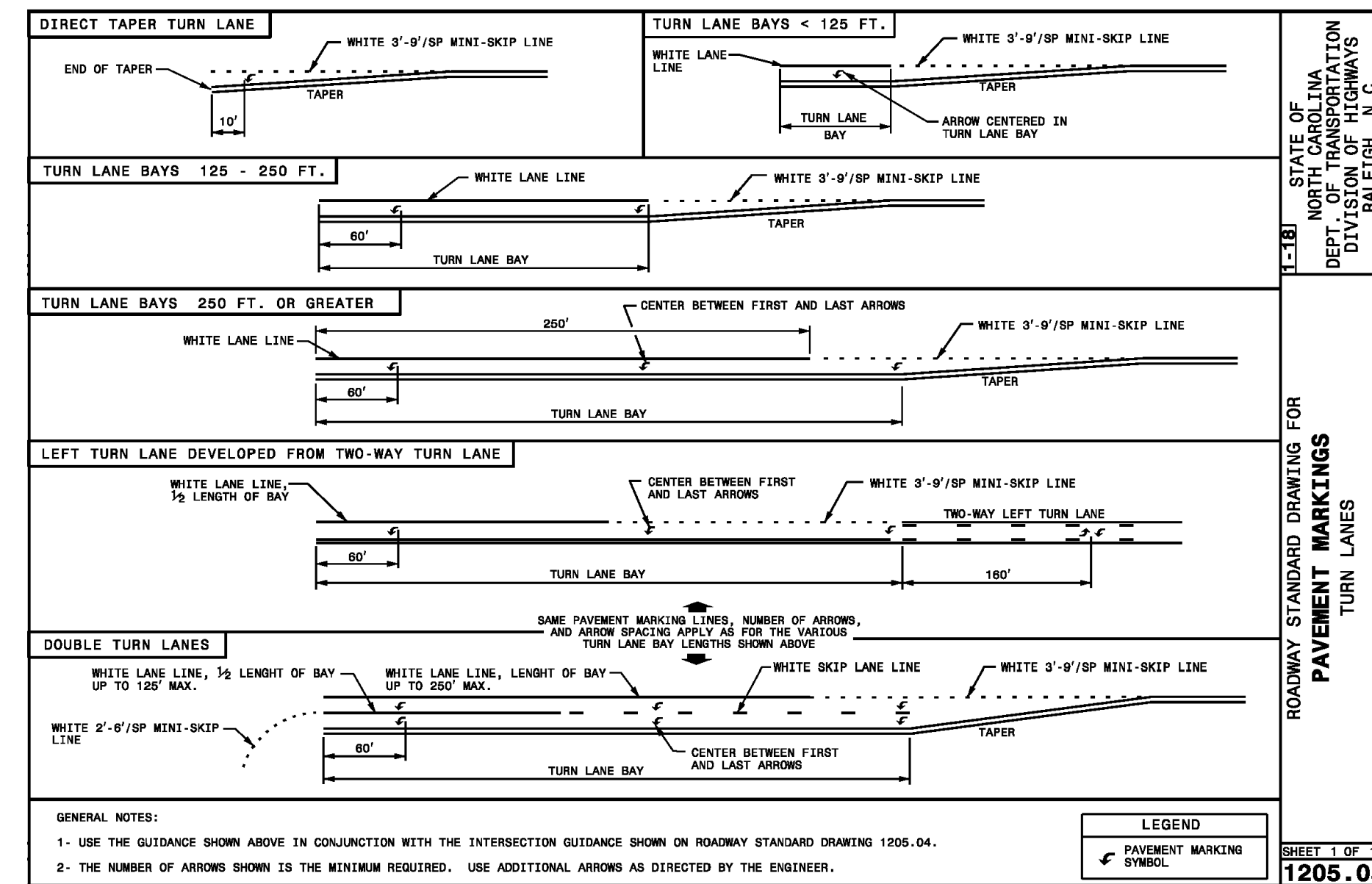
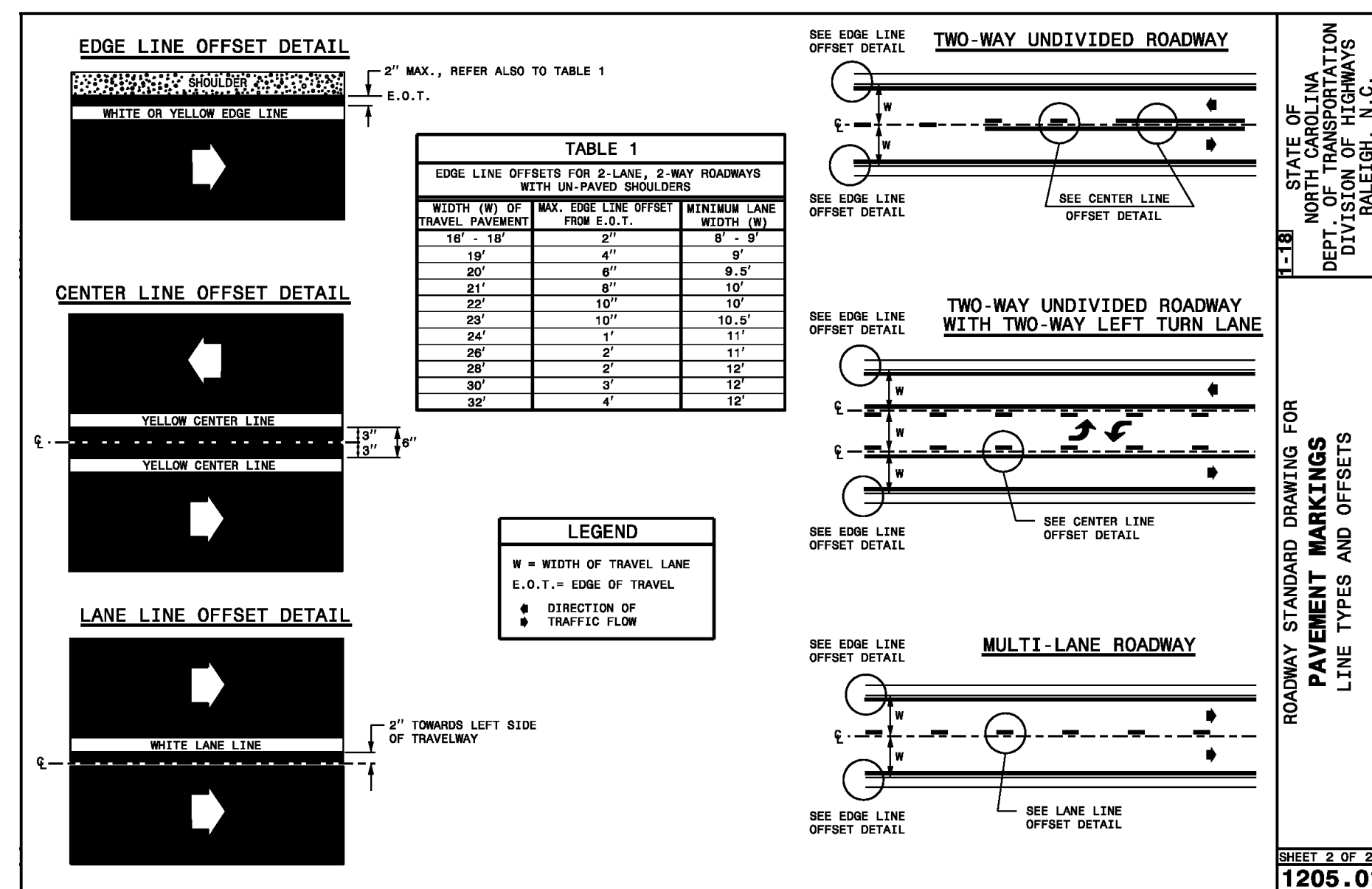
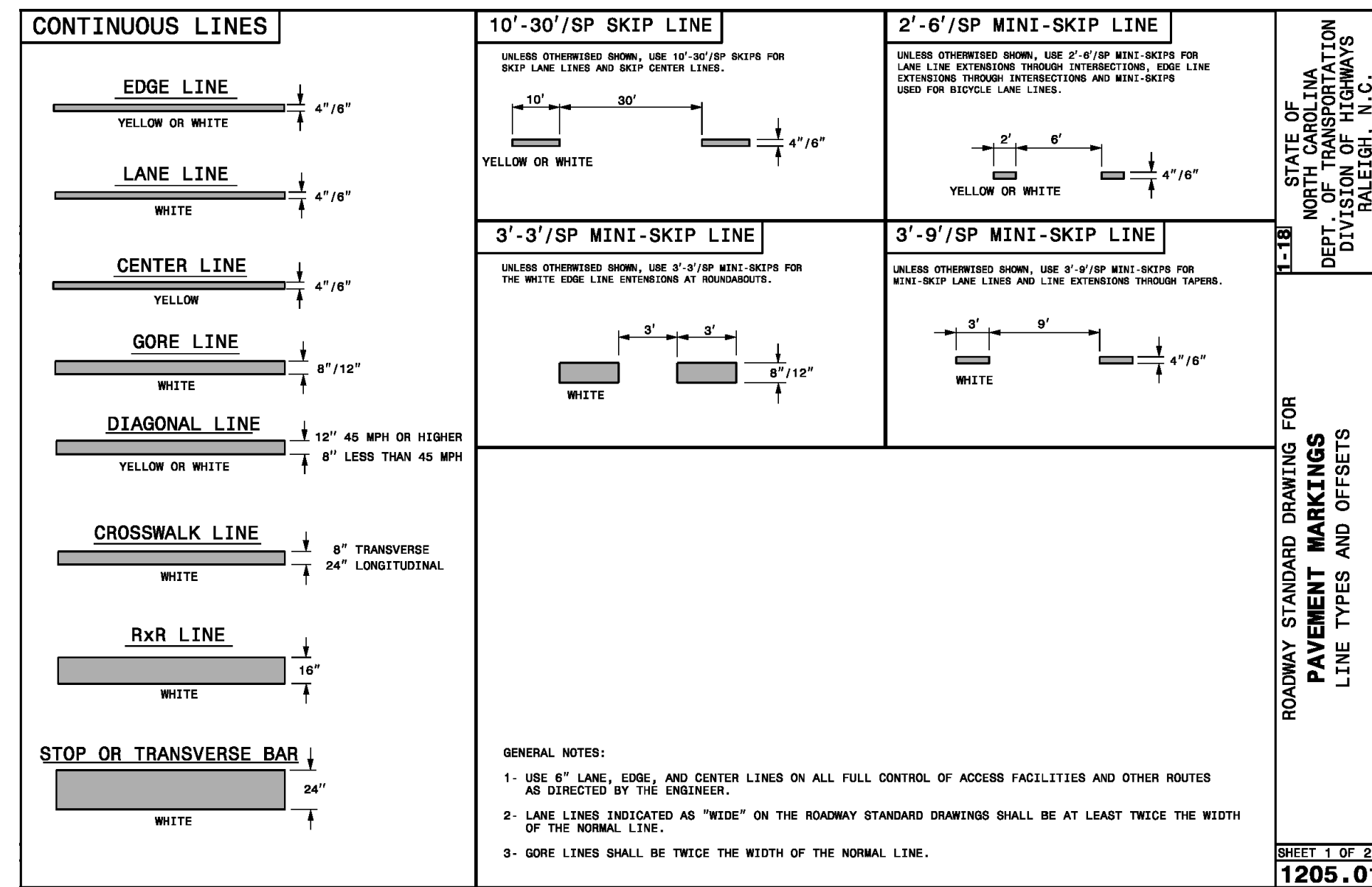

FINAL DESIGN - NOT RELEASED FOR CONSTRUCTION

RALEIGH WILMINGTON INVESTORS, LLC.
6131 FALLS OF NEUSE RD.
RALEIGH, NC 27609

PARAMOUNT ENGINEERING, INC.
122 Cinema Drive
Wilmington, North Carolina 28403
(910) 791-6707 (O) (910) 791-6760 (F)
NC License #: C-2846

MASONBORO LOOP RD (SR 1492)
DETAILS
EAST & MASON
7500 MASONBORO SOUND RD
WILMINGTON, NC, NEW HANOVER COUNTY

PROJECT STATUS:
CONCEPTUAL LAYOUT:
PRELIMINARY LAYOUT:
RELEASED FOR CONST.

DRAWING INFORMATION:
DATE: 01/22/20
AS NOTED
CHB
CIB
CIB
CIB

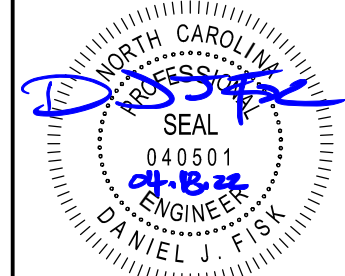

C-9.5

PEI JOB#: 19409.PE

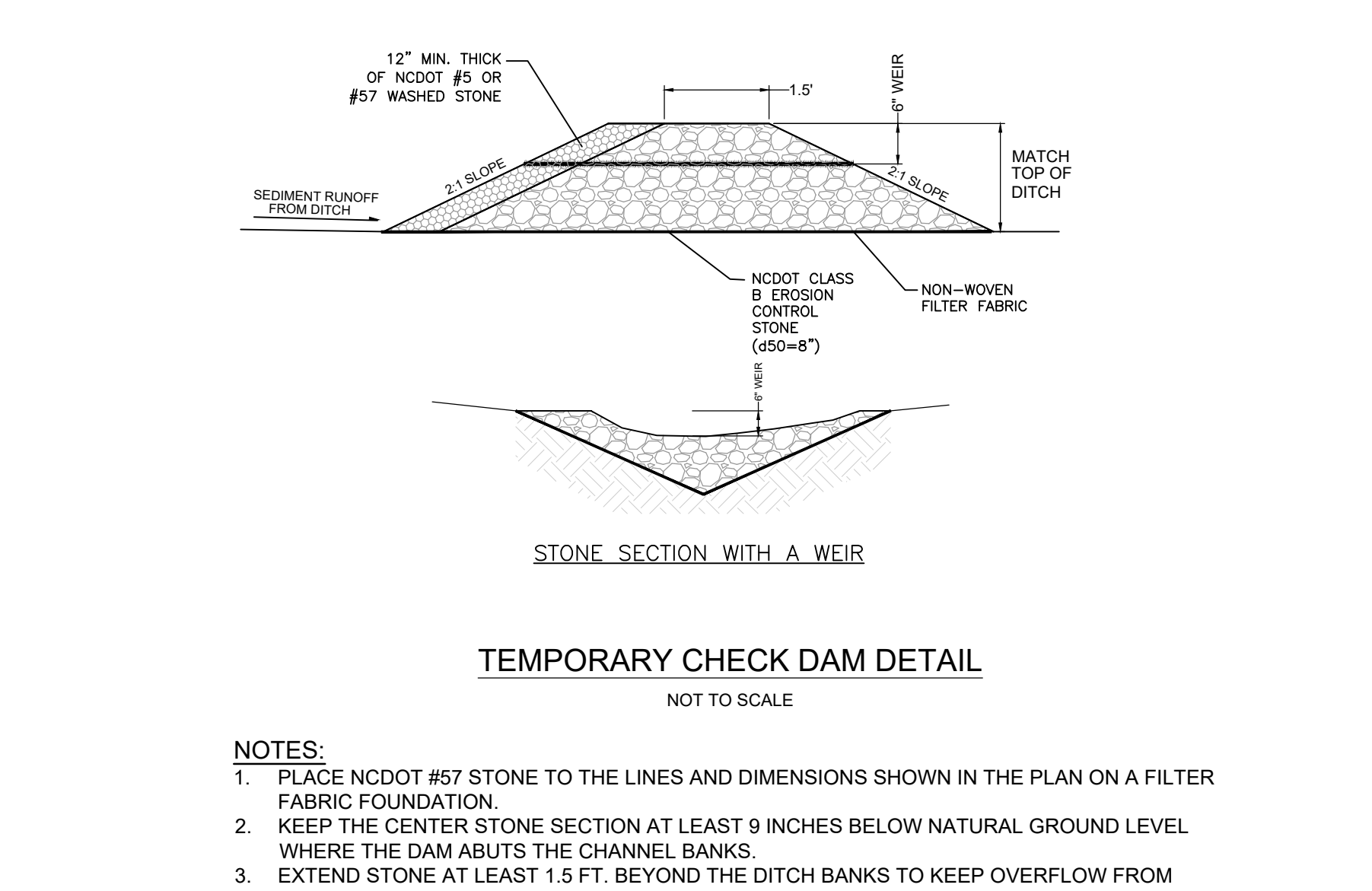
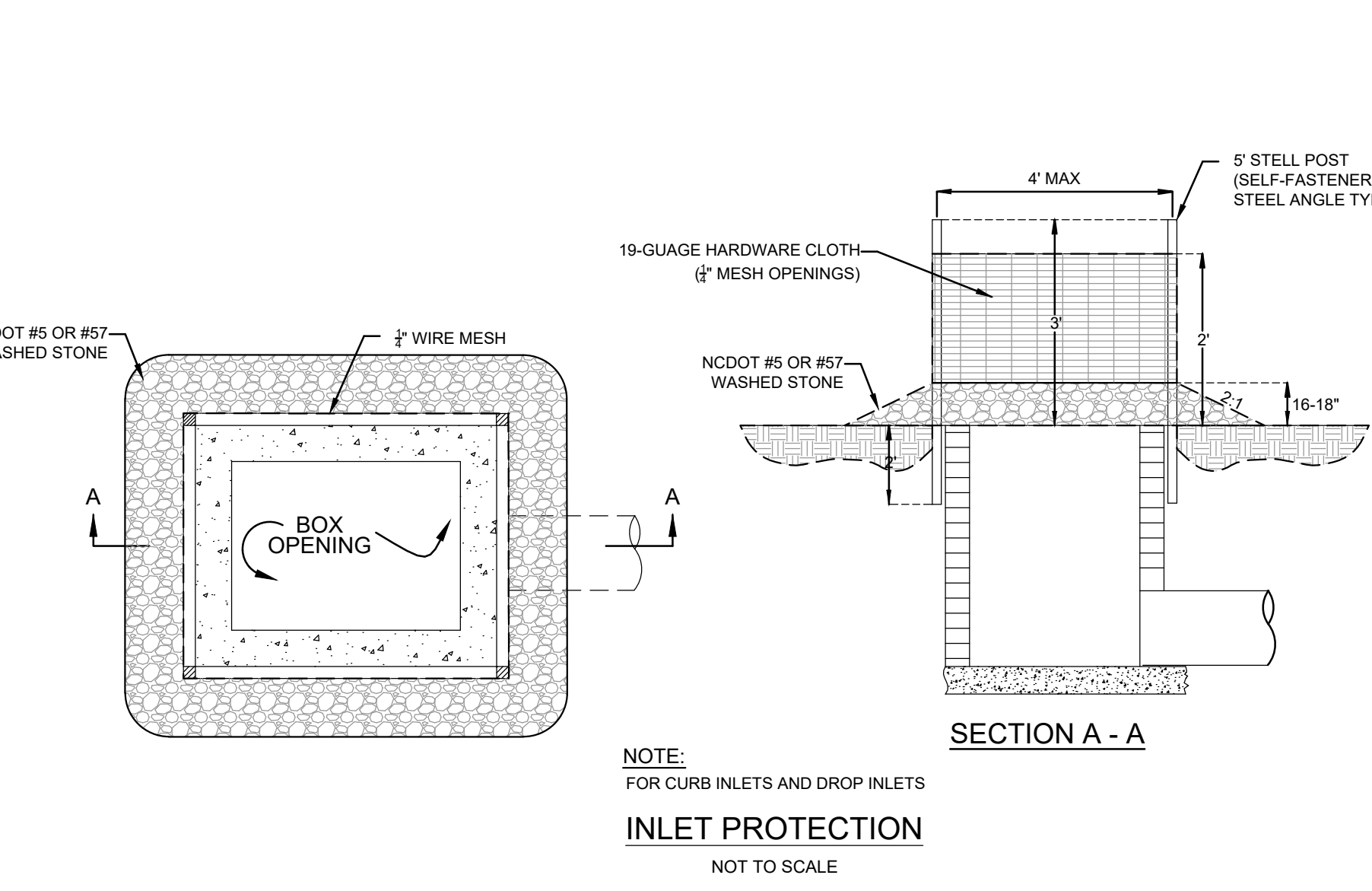
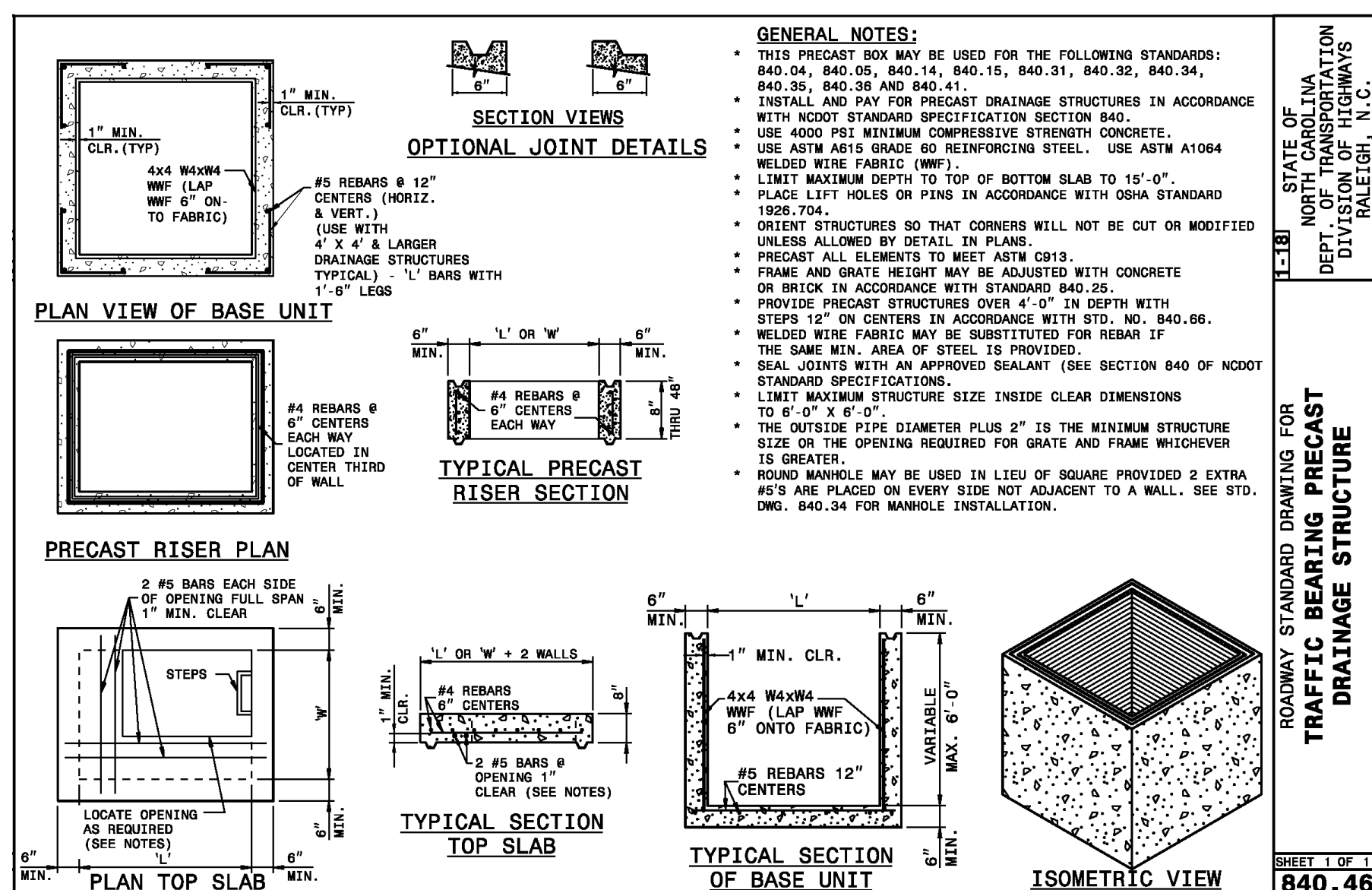
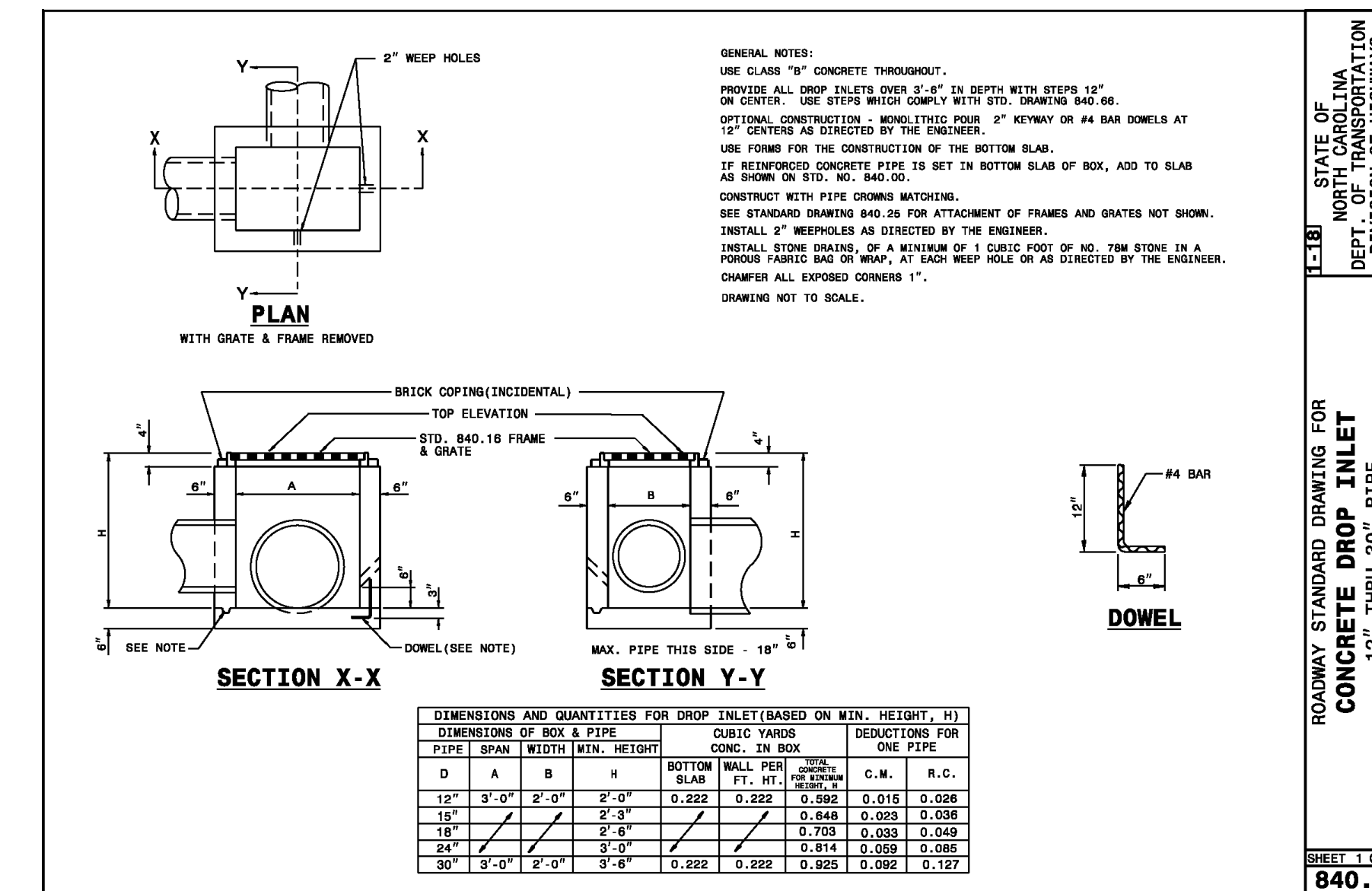
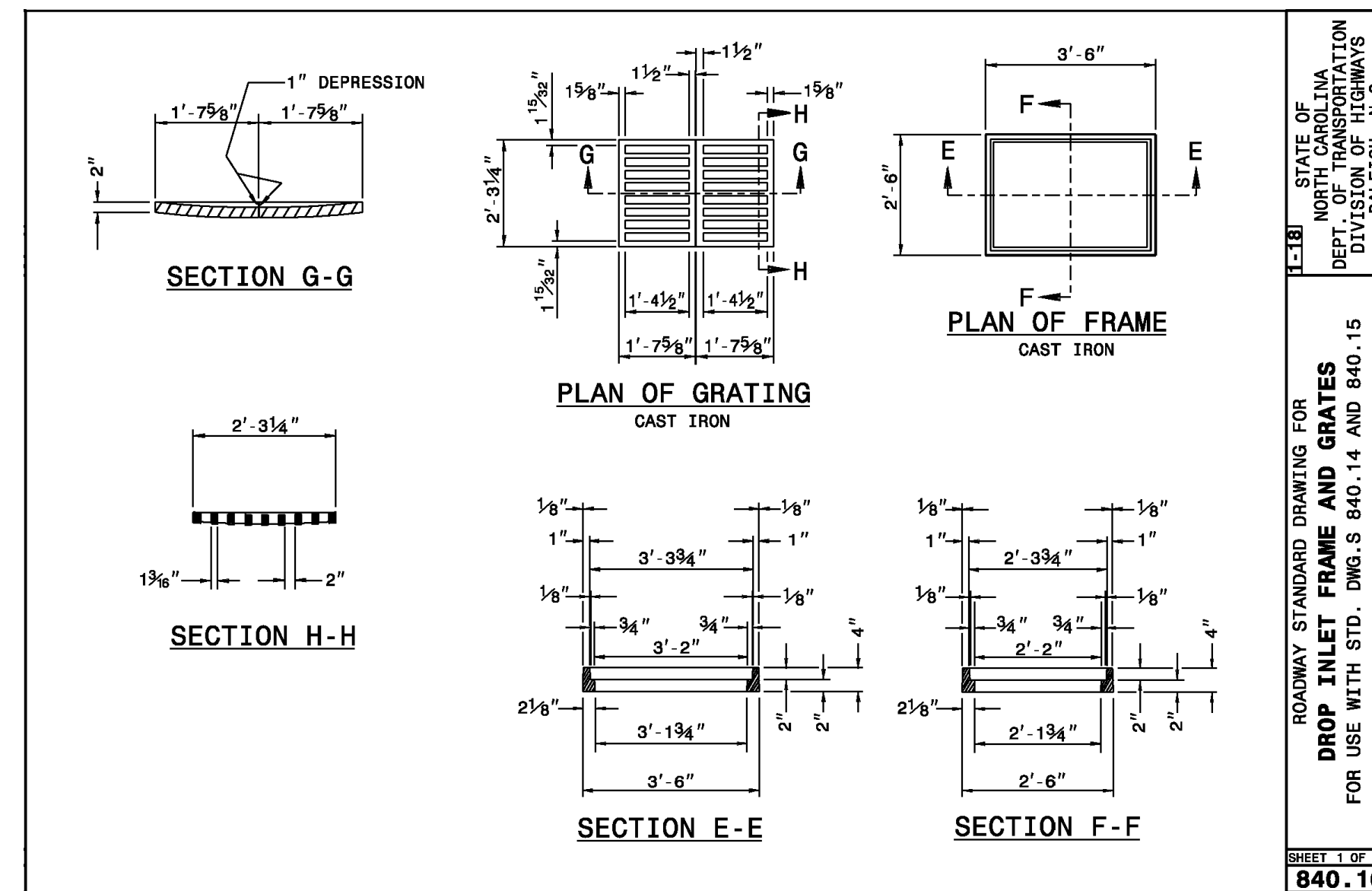
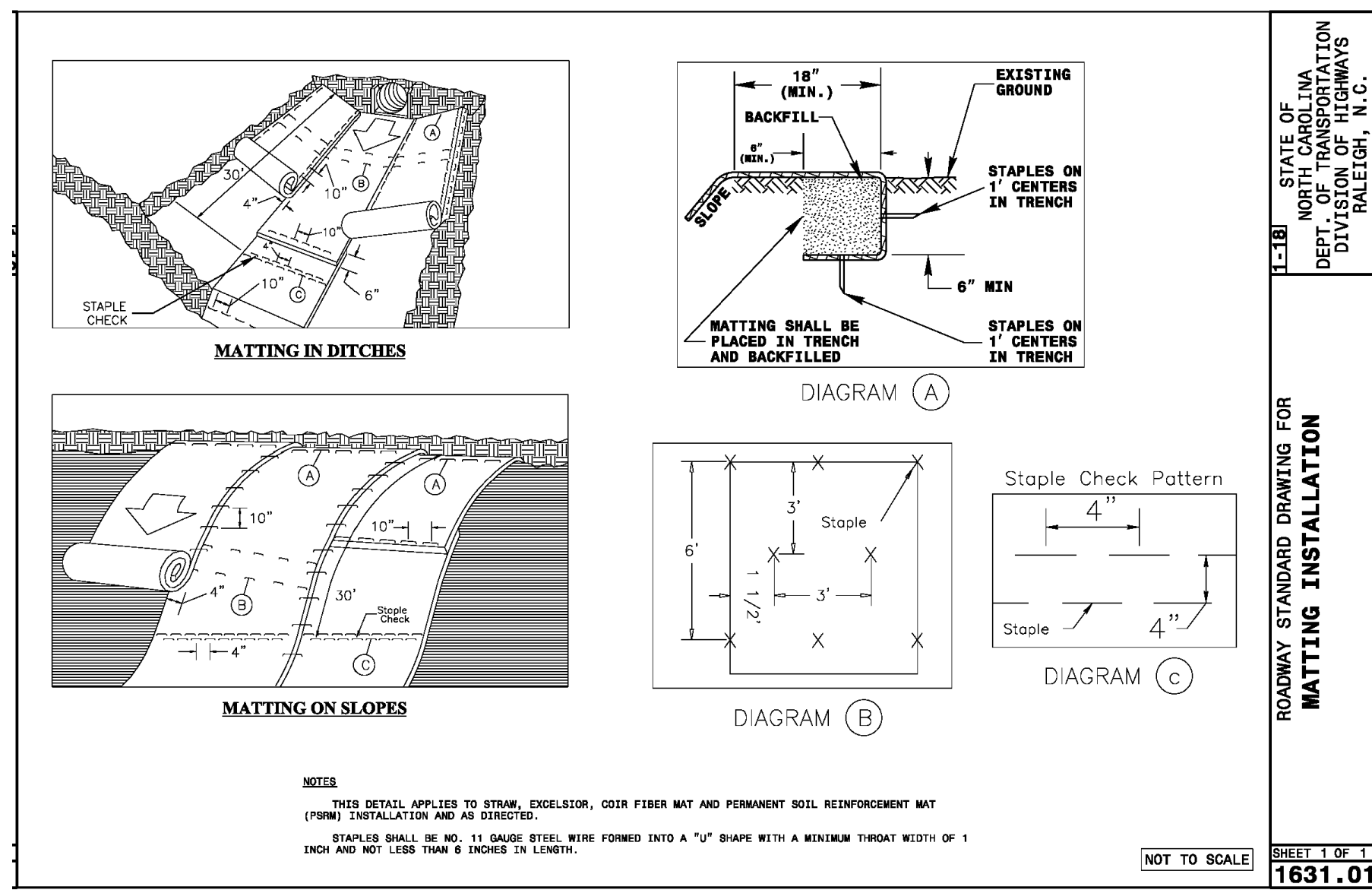
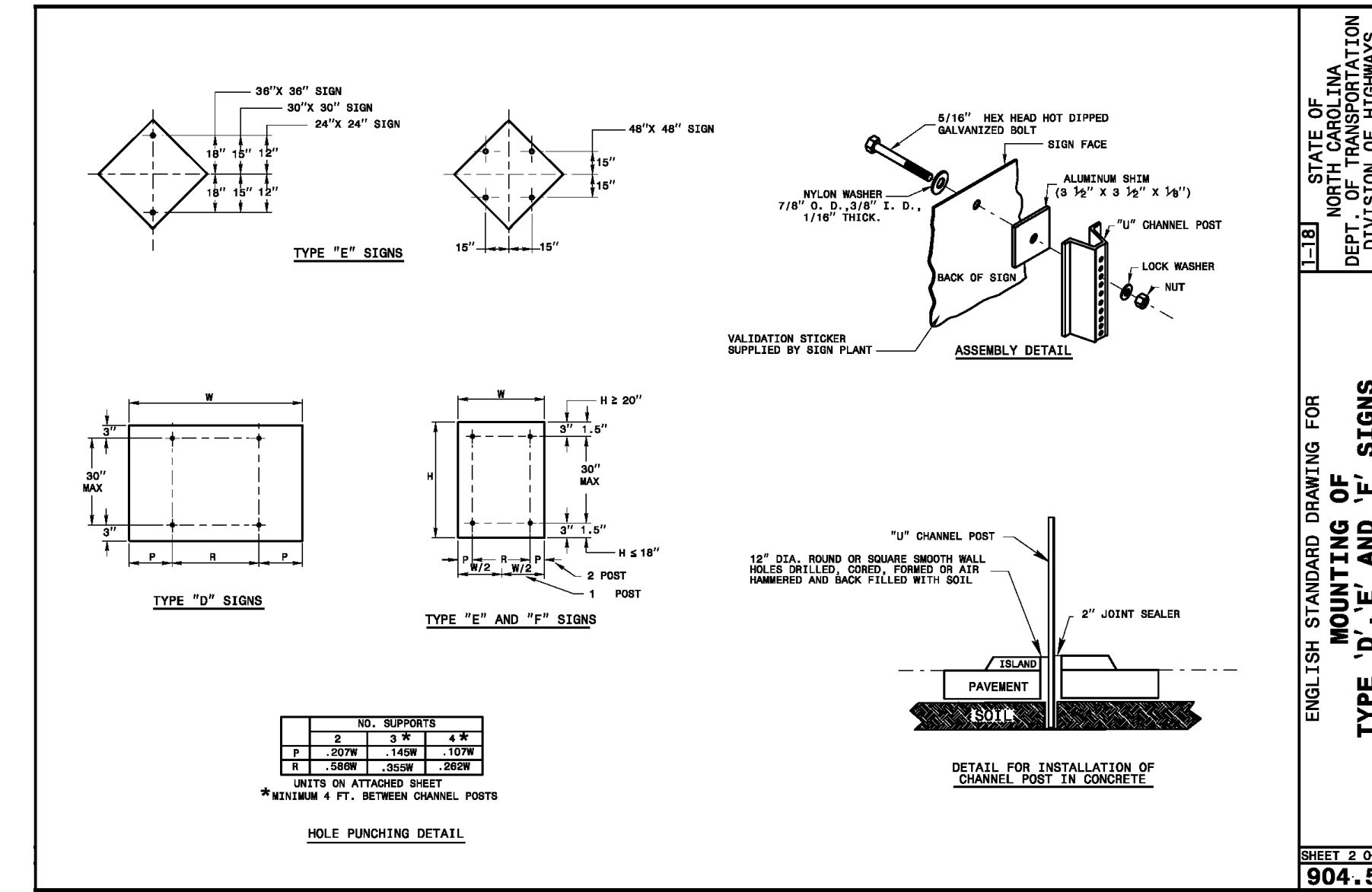
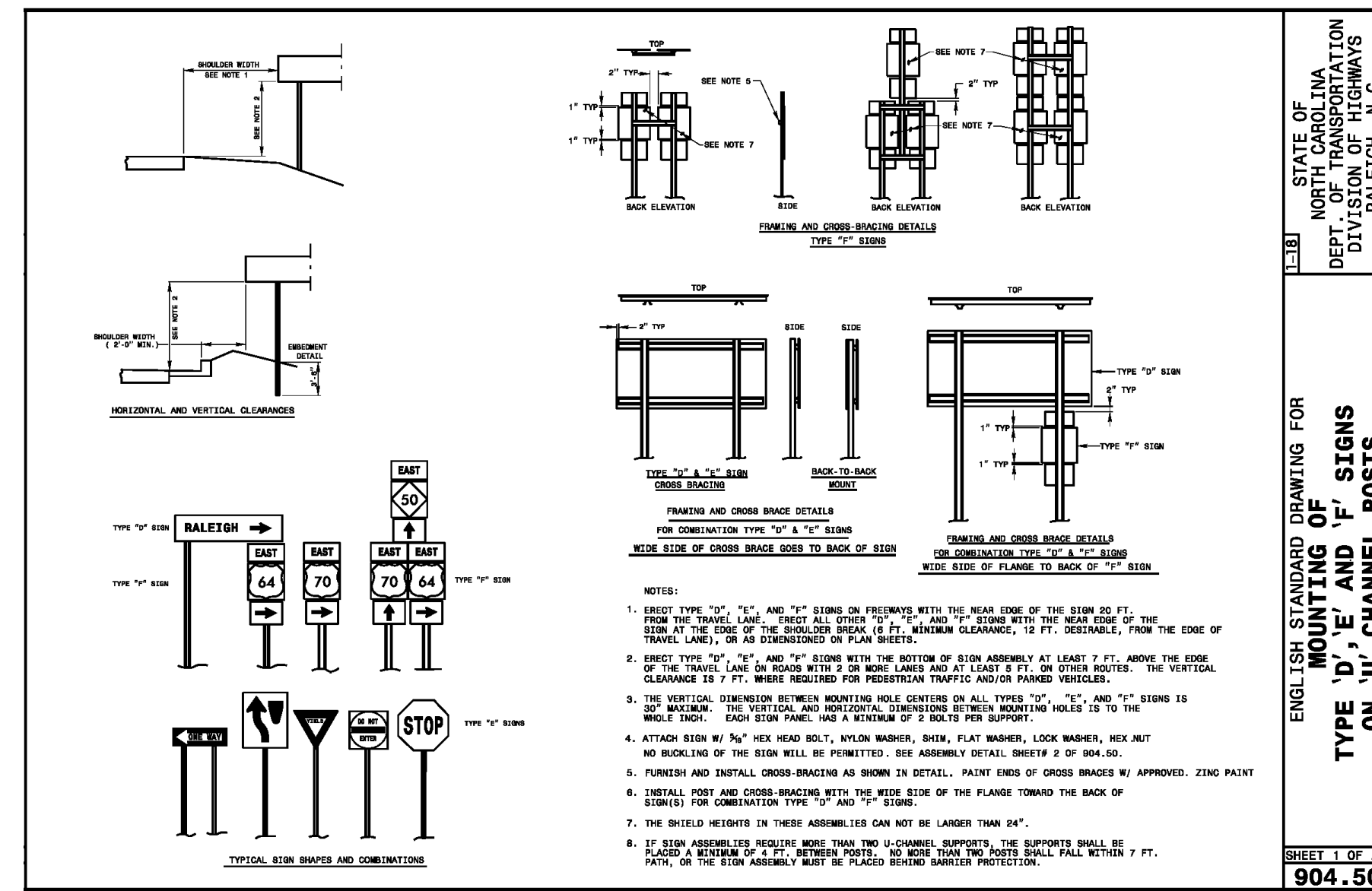
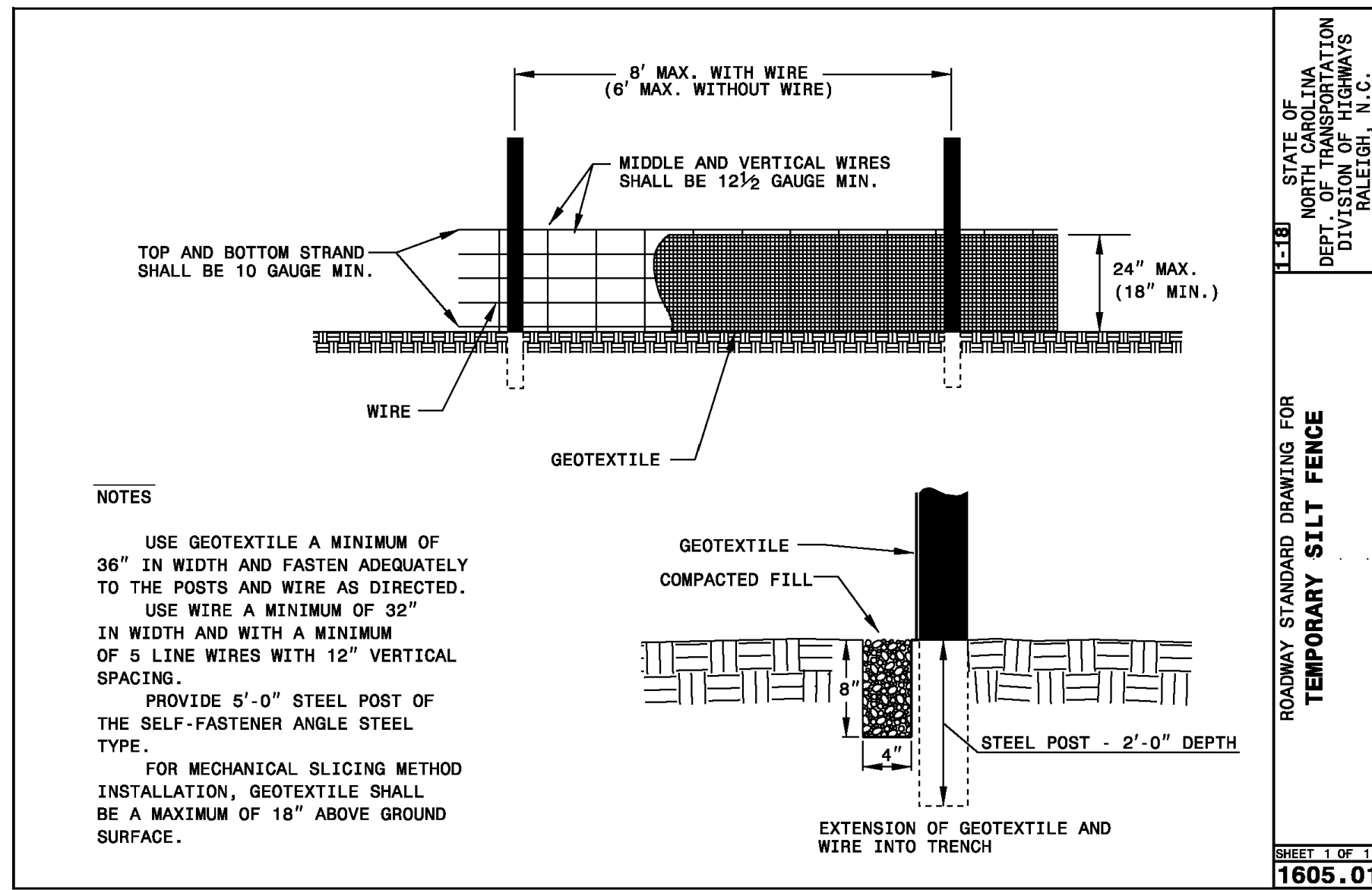

FINAL DESIGN - NOT RELEASED FOR CONSTRUCTION

RALEIGH WILMINGTON INVESTORS, LLC
6131 FALLS OF NEUSE RD.
RALEIGH, NC 27609

PARAMOUNT
ENGINEERING, INC.
122 Cinema Drive
Wilmington, North Carolina 28403
(910) 791-6707 (O) (910) 791-6760 (F)
NC License #: C-2846

EAST & MASON
7500 MASONBORO SOUND RD
WILMINGTON, NC; NEW HANOVER COUNTY

PROJECT STATUS
CONCEPTUAL LAYOUT:
PRELIMINARY LAYOUT:
RELEASED FOR CONST.
DRAWING INFORMATION
DATE: 10/12/20
BY: ASB/CHB
CHECKED: JTB
DESIGNED: JTB
DRAWN: JTB
CDS

C-9.6
PEI JOB#: 19409.PE